

1924 Portland Tax Records: 161-163 Brighton Avenue, Portland, 1924

Portland, Maine
 Assessment 19
 Name
 Owner McClaskey Samuel
 Street Brighton Ave
Dartmouth No. 161-163
 Block 82 A Lot 28
 Use of Bldg 29a family Name
 Tenants and Rooms 5 Rms 5 Rms
 Rentals 35 = \$ 0 winter
 Age 11 yrs approx
 Condition of Repair fair

Class	Exterior	Plumbing
Bungalow	Clapboards	Common
Single House	Siding	Individual
Two family	Shingles	Open
Three family	Stucco	Set tubs
Apartment	Paper	Finish
Store Building	Tapestry Brick	Plain
Office	Com. Brick	Hardwood
Factory	Galv. Iron	Halls
Storage	Stone	Wood
Stables	Terra Cotta	Terrazzo
Garage, private	Concrete	Marble
Garage, public	Heating	Roof -- Roofing
Theatre	Stove	Shingle
Club House	Furnace	Slate
Cottage	Hot Water	Gravel
	Steam	Prepared
Foundation	Light	Asbestos
Brick	Oil	Flat
Stone	Gas	Hip
Concrete	Electric	Gable
Pile		Dormers
Basement	Floor	Windows
Full	Common	Plain Glass
Cement Floor	Hardwood	Wire Glass
Waterproof	Re-Concrete	Shutters
Construction	Concrete Slab	Miscellaneous
Frame	Waterproof	Elevator
Brick	Ceiling	Sprinkler
Tile	Plaster	Fire Escape
Blocks	Metal	Refrigerator
Stucco	Panelled	Vacuum Cleaner
Re-Concrete	Rough	Safes and Vaults
Mill		Telephone Equip.
Steel Frame		

Ground Area 1059 Height 21
 Cubic Feet 22829 Unit 16 cts 50
 Utility Dep.
 Dep. 15 Per cent.
 Sound Value, \$ 4465

Land 4100 Corner Interior Alley
 Front Depth = ft.
 COMPUTATION
 $4100 \times 130 \times 20 = 1066$
 $4100 \times 20 = 102$
1168
420
1588

Area	Multiplier	Coefficient

Year	Unit	Coefficient	Land Value
19			<u>1588</u>

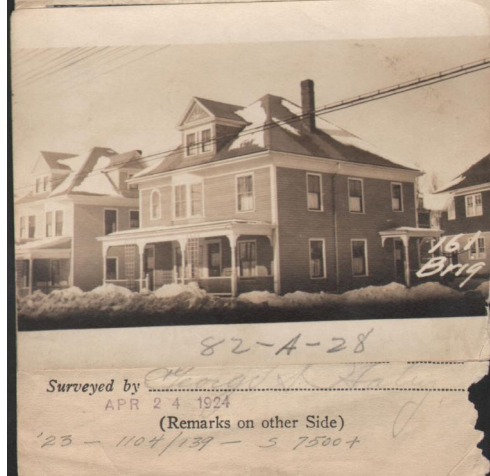

Remarks about Buildings
 $31.08 \times 34.08 \times 31 = 32829$
 1059

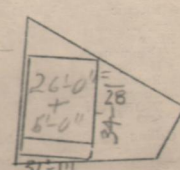
Remarks about Land

 BRIGHTON AVE.

Remarks about Personal Property

Category	Value
3 Building Values Added	<u>1100</u>
4 Building Values Placed	<u>400</u>
5 Building Values Extended	
6 Land Only Questionnaire Made	
7 Land Values Placed	
8 Land Values Extended	
9 Compared With 1923	
10 Personal Property Added	

1924 Portland Tax Records: 161-163 Brighton Avenue, Portland, 1924

www.maine-memory.net/item/35064
Collections of City of Portland - Planning & Development



Owner: Samuel McClaskey
Address: 161-163 Brighton Avenue, Oakdale, Portland, Maine
Use: Dwelling - Two family
Local Code: Block 82A Lot 28 Book 10 Page 1
MMN item number: 35064