

1924 Portland Tax Records: 320-322 Commercial Street, Portland, 1924

Portland, Maine
 NON-RESIDENT ^{L3100} ^{B7000}
 Assessment 19
 Name Stott David Flour Mills
 Owner Stott David Flour Mills
 Street Commercial No. 320-322
 Block 41 E Lot 1 W
 Use of Bldg: Storage Flour - Lumber Name
 Tenants and Rooms Two
 Rentals Annual
 Age Not (1896)
 Condition of Repair Good

- | | | |
|---------------------|-----------------|-----------------------|
| Class | Exterior | Plumbing |
| Bungalow | Clapboards | Common |
| Single House | Siding | Individual |
| Two family | Shingles | Open |
| Three family | Stucco | Set tubs |
| Apartment | Paper | Finish |
| Store Building | Tapestry Brick | Plain |
| Office " | Com. Brick | Hardwood office |
| Factory " | Galv. Iron | |
| Storage " | Stone | Halls |
| Stables | Terra Cotta | Wood |
| Garage, private | Concrete | Terrazzo |
| Garage, public | | Marble |
| Theatre | Heating | Roof - Roofing |
| Club House | Stove | Shingle |
| Cottage | Furnace | Slate |
| | Hot Water | Gravel |
| | Steam | Prepared |
| Foundation | | Asbestos |
| Brick <u>bers</u> | Light | Flat |
| Stone | Oil | Hip |
| Concrete | Gas | Gable |
| Pile | Electric | Dormers |
| Basement | | Windows |
| Full | Floor | Plain Glass |
| Cement Floor | Common | Wire Glass |
| Waterproof | Hardwood | Shutters |
| Construction | Re-Concrete | Miscellaneous |
| Frame | Concrete Slab | Elevator |
| Brick | Waterproof | Sprinkler |
| Tile | Ceiling | Fire Escape |
| Blocks | Plaster | Refrigerator |
| Stucco | Metal | Vacuum Cleaner |
| Re-Concrete | Panelled | Safes and Vaults |
| Mill | Rough | Telephone Equip. |
| Steel Frame | | |

Ground Area 3435 Height 25
 Cubic Feet 1,10,825 Unit 17 cts. (7900)
 Utility Dep. 40 Per cent.
 Dep. 40 Per cent.
 Sound Value, \$ 7979

Land 4500 Corner Interior Alley
 Front Depth = ft.
 COMPUTATION

Area	Multiplier	Coefficient	
4500	88	3960	
Year	Unit	Coefficient	Land Value
17	70	3960	\$2772 (2775)



Remarks about Buildings

47X 22.5 + 325 = 1410
 72.75 X 37.5 = 2728
 237.5 X 75.75 = 295
 4433
 110825 Ca. A.

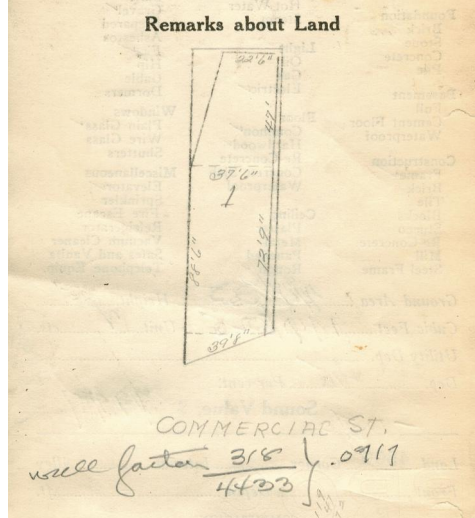

Remarks about Personal Property
 flow factor $\frac{7}{75} = 0.0933$

CITY OF PORTLAND, MAINE
 ASSESSORS DEPARTMENT

CHART	CLOCK
3 - Building Volumes Checked	7/4/22
4 - Building Values Placed	
5 - Building Values Extended	
6 - Land Only Questionnaire Made	
7 - Land Values Placed	
8 - Land Values Extended	
9 - Compared with 1923	
10 - Personal Property Added	

1924 Portland Tax Records: 320-322 Commercial Street, Portland, 1924

www.mainmemory.net/item/37372
Collections of City of Portland - Planning & Development



Owner: Storr David Flour Mills
Address: 320-322 Commercial Street, Waterfront, Portland, Maine
Use: Storage - Flour & Lumber
Local Code: Block 41E Lot 1 Book 16 Page 1
MMN item number: 37372