

1924 Portland Tax Records: 760 Congress Street, Portland, 1924

Portland, **NON-RESIDENT** Maine
Assessment 19
 Name *Bramhall Realty Co.*
 Owner *Barrett, Joan H.*
 Street *Congress* No. *760*
 Block *Neal* Lot *12*
 Use of Bldg. *Dwelling* Name _____
 Tenants and Rooms *Vacant - about 9 mos*
 Rentals _____
 Age *75 yrs approx*
 Condition of Repair *Ext. Fair Int. Poor*

Class	Exterior	Plumbing
<input checked="" type="checkbox"/> Bungalow	Clapboards	Common
<input checked="" type="checkbox"/> Single House	Siding	Individual
<input checked="" type="checkbox"/> Two family	Shingles	<input checked="" type="checkbox"/> Open
<input checked="" type="checkbox"/> Three family	Stucco	Set tubs
<input checked="" type="checkbox"/> Apartment	Paper	
<input checked="" type="checkbox"/> Store Building	Tapestry Brick	Finish
Office	Com. Brick	<input checked="" type="checkbox"/> Plain
Factory	Galv. Iron	Hardwood
Storage	Stone	
Stables	Terra Cotta	Halls
Garage, private	Concrete	<input checked="" type="checkbox"/> Wood
Garage, public		Terrazzo
Theatre		Marble
Club House	Heating	Roof - Roofing
Cottage	Stove	Shingle
	Furnace	Slate
	Hot Water	Gravel
	Steam	Prepared
Foundation		Asbestos
<input checked="" type="checkbox"/> Brick	Light	Flat
<input checked="" type="checkbox"/> Stone	Oil	Hip
<input checked="" type="checkbox"/> Concrete	Gas	Gable
<input checked="" type="checkbox"/> Pile	Electric	Dormers
Basement		<i>miscellaneous</i>
<input checked="" type="checkbox"/> Full	Floor	Windows
<input checked="" type="checkbox"/> Cement Floor	Common	<input checked="" type="checkbox"/> Plain Glass
<input checked="" type="checkbox"/> Waterproof	Hardwood	Wire Glass
	Re-Concrete	Shutters
Construction	Concrete Slab	
Frame	Waterproof	Miscellaneous
<input checked="" type="checkbox"/> Brick		Elevator
Tile	Ceiling	Sprinkler
Blocks	Plaster	Fire Escape
Stucco	Metal	Refrigerator
Re-Concrete	Panelled	Vacuum Cleaner
Mill	Rough	Safes and Vaults
Steel Frame		Telephone Equip.

Ground Area *1113* Height *26'-05"*
 Cubic Feet *39571* Unit *18* Cts. *37/10*
 Utility Dep. _____
 Dep. *45* Per cent.
 - Sound Value, \$ *3918*

Land *2205* Corner _____ Interior _____ Alley _____
 Front _____ Depth _____ = _____ ft.
(2579) COMPUTATION
 $2205 \times 117 \times 2 = 518$
 $2205 \times 65 = 716$
 $518 + 716 = 1234$
 $1234 \div 2 = 617$
 Area *8,395.0* Multiplier _____ Coefficient _____
 Year Unit Coefficient Land Value
 19 _____ # *7163*



Surveyed by *F. Lord, Dionis & Company*
 (Remarks on other Side) *5/9/24*
 4 - 1161/104 - 14,792+

Remarks about Buildings

18'3"
4
22'3"

Remarks about Land

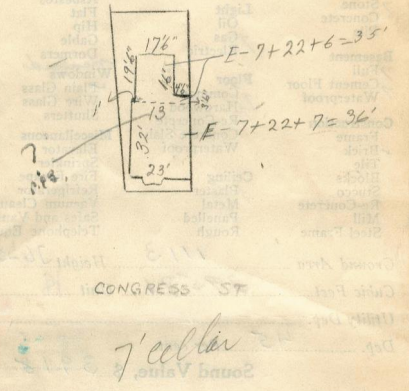

Remarks about Personal Property

- 1 Bay - 6'6" x 26' x 27'6"*
- $6.5 \times 2.5 = 16 \times 27.5 = 440$
 - $23 \times 32 = 736 \times 36 = 26496$
 - $3.5 \times 23 = 81 \times 35 = 2835$
 - $17.5 \times 16 = 280 \times 35 = 9800$
- 39571*

CITY OF PORTLAND, MAINE		
ASSESSORS DEPARTMENT		
CHART	BLOCK	
3	Building Volumes Checked	<i>ROAD 197</i>
4	Building Values Filed	
5	Building Values Indexed	<i>State</i>
6	Land Only Questionnaire Made	
7	Land Values Filed	
8	Land Values Extended	
9	Compared With 1923	
10	Personal Property Added	

1924 Portland Tax Records: 760 Congress Street, Portland, 1924

www.maine-memory.net/item/47815
Collections of City of Portland - Planning & Development



Owner: John H Barrenter
Address: 760 Congress Street, West End, Portland, Maine
Use: Dwelling - Single family
Local Code: Block 54F Lot 13 Book 20 Page 1
MMN item number: 47815
Notes: This property was subsequently owned by Bramhall Realty