

1924 Portland Tax Records: 81-83 Franklin Street, Portland, 1924

Portland, Maine
 Assessment 1924
 Name *Geisinger H*
 Owner *Huberman Mary Backman M.D.*
 Street *Franklin garage* No. *81-83*
 Block *28 C* Lot *11*
 Use of Bldg. *Garage* Name
 Tenants and Rooms *occ. by owner*
 Rentals
 Age *7*
 Condition of Repair *Good*

| Class | Exterior | Plumbing |
|-----------------|----------------|------------------|
| Bungalow | Clapboards | Common |
| Single House | Siding | Individual |
| Two family | Shingles | Open |
| Three family | Stucco | Set tubs |
| Apartment | Paper | Finish |
| Store Building | Tapestry Brick | Plain |
| Office | Com. Brick | Hardwood |
| Factory | Galv. Iron | Halls |
| Storage | Stone | Wood |
| Stables | Terra Cotta | Terrazzo |
| Garage, private | Concrete | Marble |
| Garage, public | | |
| Theatre | Heating | Roof - Roofing |
| Club House | Stove | Shingle |
| Cottage | Furnace | Slate |
| | Hot Water | Gravel |
| Foundation | Steam | Prepared |
| Brick | | Asbestos |
| Stone | Light | Flat |
| Concrete | Oil | Hip |
| Pile | Gas | Gable |
| Basement | Electric | Dormers |
| Full | | Windows |
| Cement Floor | Floor | Plain Glass |
| Waterproof | Common | Wire Glass |
| | Hardwood | Shutters |
| Construction | Re-Concrete | Miscellaneous |
| Frame | Concrete Slab | Elevator |
| Brick | Waterproof | Sprinkler |
| Tile | | Fire Escape |
| Block | Ceiling | Refrigerator |
| Stone | Plaster | Vacuum Cleaner |
| Re-Concrete | Metal | Safes and Vaults |
| Mill | Panelled | Telephone Equip. |
| Steel Frame | Rough | |

Ground Area *6346* ✓ Height *20*
 Cubic Feet *126920* ✓ Unit *12* cts.
 Utility Dep.
 Dep. *15* Per cent.
 Sound Value, \$ *12946*
 Land *3456* Corner Interior Alley
 Front *7007* Depth = ft.

COMPUTATION

R-29-2950

| Area | Multiplier | Coefficient |
|-------------|------------|-----------------------------|
| <i>7007</i> | <i>100</i> | <i>7007</i> ³¹⁵⁰ |
| Year | Unit | Coefficient |
| <i>19</i> | <i>50</i> | <i>7007</i> |
| | | <i>3503</i> |

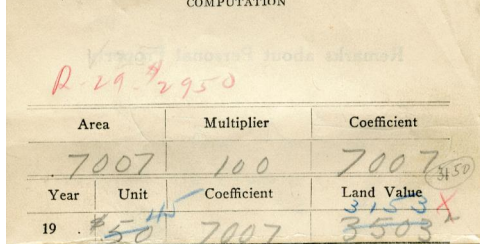

1-26-911-OK? good

Surveyed by *PAH*
 MAY 1 1924
 (Remarks on other Side)
23-1116/210
23-1128/426-39500+ over

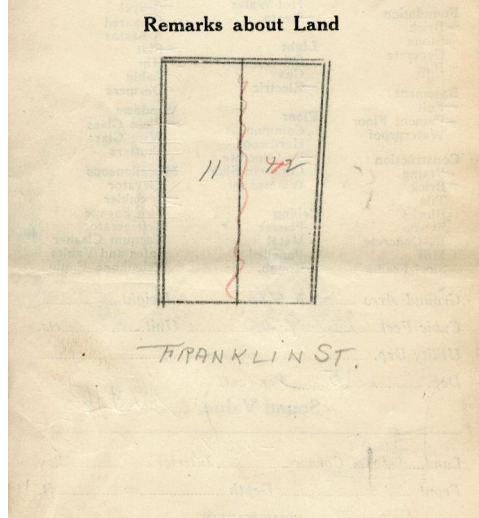
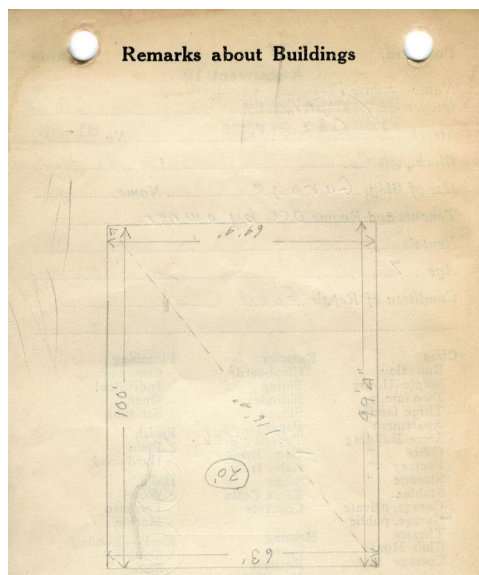

Remarks about Personal Property

64 x *100*
 $(\frac{64.33 + 63}{2}) (\frac{100 + 99.33}{2}) \times 20$
 $6400 \times 20 = 128000$
 SF

6346-126920

| CITY OF PORTLAND, MAINE | |
|-------------------------|------------------------------|
| ASSESSORS DEPARTMENT | |
| CHART | BLOCK |
| 3 | Building Volumes Checked |
| 4 | Building Values Placed |
| 5 | Building Values Extended |
| 6 | Land Only Questionnaire Made |
| 7 | Land Values Placed |
| 8 | Land Values Extended |
| 9 | Compared With 1923 |
| 10 | Personal Property Added |
| | <i>+09204</i> |
| | <i>707/681</i> |

100
 $\frac{6400 \times 20}{2} = 64000$
 $64000 + 09204 = 73204$
128000
 $128000 + 73204 = 201204$
128000

1924 Portland Tax Records: 81-83 Franklin Street, Portland, 1924



Owner: Mary Huberman
Address: 81-83 Franklin Street, East End, Portland, Maine
Use: Garage, public
Local Code: Block 28C Lot 11 Book 33 Page 1
MMN item number: 52513
Notes: The property was subsequently owned by H. Geisinger. The property was subsequently owned by M.J. Backman.