

1924 Portland Tax Records: 1249 Forest Avenue, Portland, 1924

Portland, Maine
 Assessment 19 ¹⁰⁷² ^{L 500} ^{R 1300} lots 1-2
 Name White Mabel E
 Street Forest Ave ^{Elevation} No. 1249
 Block 292C Lot 526
 Use of Bldg. Dwelling Name _____
 Tenants and Rooms. one family - 6 rooms
 Rentals occupied by owner
 Age 100 years
 Condition of Repair Fair

Class <input checked="" type="checkbox"/> Bungalow <input type="checkbox"/> Single House <input type="checkbox"/> Two family <input type="checkbox"/> Three family <input type="checkbox"/> Apartment <input type="checkbox"/> Store Building <input type="checkbox"/> Office <input type="checkbox"/> Factory <input type="checkbox"/> Storage <input type="checkbox"/> Stables <input type="checkbox"/> Garage, private <input type="checkbox"/> Garage, public <input type="checkbox"/> Theatre <input type="checkbox"/> Club House <input type="checkbox"/> Cottage	Exterior <input checked="" type="checkbox"/> Clapboards <input type="checkbox"/> Siding <input type="checkbox"/> Shingles <input type="checkbox"/> Stucco <input type="checkbox"/> Paper <input type="checkbox"/> Tapestry Brick <input type="checkbox"/> Com. Brick <input type="checkbox"/> Galv. Iron <input type="checkbox"/> Stone <input type="checkbox"/> Terra Cotta <input type="checkbox"/> Concrete	Plumbing <input checked="" type="checkbox"/> Common <input type="checkbox"/> Individual <input type="checkbox"/> Open <input type="checkbox"/> Set tubs
Foundation <input checked="" type="checkbox"/> Brick <input type="checkbox"/> Stone <input type="checkbox"/> Concrete <input type="checkbox"/> Pile	Heating <input type="checkbox"/> Stove <input checked="" type="checkbox"/> Furnace <input type="checkbox"/> Hot Water <input type="checkbox"/> Steam	Finish <input checked="" type="checkbox"/> Plain <input type="checkbox"/> Hardwood
Basement <input type="checkbox"/> Full <input checked="" type="checkbox"/> Cement Floor <input type="checkbox"/> Waterproof	Light <input type="checkbox"/> Oil <input type="checkbox"/> Gas <input checked="" type="checkbox"/> Electric	Halls <input checked="" type="checkbox"/> Wood <input type="checkbox"/> Terrazzo <input type="checkbox"/> Marble
Construction <input checked="" type="checkbox"/> Frame <input type="checkbox"/> Brick <input type="checkbox"/> Tile <input type="checkbox"/> Blocks <input type="checkbox"/> Stucco <input type="checkbox"/> Re-Concrete <input type="checkbox"/> Mill <input type="checkbox"/> Steel Frame	Floor <input type="checkbox"/> Common <input type="checkbox"/> Hardwood <input type="checkbox"/> Re-Concrete <input type="checkbox"/> Concrete Slab <input type="checkbox"/> Waterproof	Roof - Roofing <input checked="" type="checkbox"/> Shingle <input type="checkbox"/> Slate <input type="checkbox"/> Gravel <input type="checkbox"/> Prepared <input type="checkbox"/> Asbestos <input type="checkbox"/> Flat <input type="checkbox"/> Hip <input checked="" type="checkbox"/> Gable <input type="checkbox"/> Dormers
Ground Area <u>1224</u>	Height <u>18-10</u>	Windows <input checked="" type="checkbox"/> Plain Glass <input type="checkbox"/> Wire Glass <input type="checkbox"/> Shutters
Cubic Feet <u>23352</u>	Unit <u>20</u> cts.	Miscellaneous <input type="checkbox"/> Elevator <input type="checkbox"/> Sprinkler <input type="checkbox"/> Fire Escape <input type="checkbox"/> Refrigerator <input type="checkbox"/> Vacuum Cleaner <input type="checkbox"/> Safes and Vaults <input type="checkbox"/> Telephone Equip.
Utility Dep. _____	Dep. <u>70</u> Per cent.	
Sound Value, \$ <u>1401</u>		

Land 1367 14025 Corner _____ Interior _____ Alley _____
 Front _____ Depth _____ = _____ ft.
 COMPUTATION
 $8620 \times 100 \times .12 = 1034$
 $8620 \times .02 = 1724$
 $1034 + 1724 = 2758$
 $4547 \times 106 = 482002$
 $4025 \times 100 \times .02 = 8050$
 $2758 + 8050 = 10808$

Area	Multiplier	Coefficient
		\$1175

Year	Unit	Coefficient	Land Value
19		#1175	#1330



Surveyed by L.K. Carney
 JUN 2 1924
 (Remarks on other Side) 1072

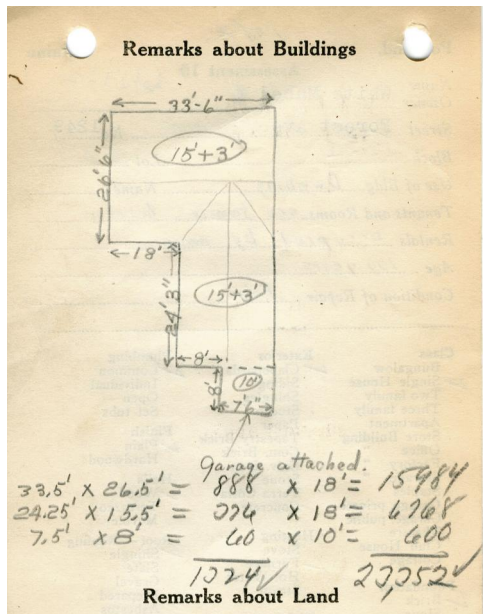

Remarks about Personal Property

CITY OF PORTLAND, MAINE
 ASSESSORS DEPARTMENT

CHART	BLOCK
3	Building Volumes Checked <u>dc</u>
4	Building Values Placed
5	Building Values Extended <u>CHINA</u>
6	Land City Questionnaire Made
7	Land Values Placed
8	Land Values Extended
9	Completed July 1923
10	Personal Property Added

1924 Portland Tax Records: 1249 Forest Avenue, Portland, 1924



Owner: Mabel E. White
Address: 1249 Forest Avenue, Morrill's Corner, Portland, Maine
Use: Dwelling - Single family
Local Code: Block 292C Lot 5 Book 38 Page 1
MMN item number: 55784