

1924 Portland Tax Records: 1335 Forest Avenue, Portland, 1924

Portland, Maine
 Assessment 19 4100
 Name Shaw Albion W.
 Owner Shaw Albion W.
 Street Forest Ave No. 1335
 Block 341-H Lot 4
 Use of Bldg. Dwelling Name _____
 Tenants and Rooms 1 - 6 rms. + bath
 Rentals Owner lives here
 Age 25 yrs.
 Condition of Repair Fairly good inside
+ out

- | | | |
|---------------------|-----------------|----------------------|
| Class | Exterior | Plumbing |
| Bungalow | -Clapboards | Common |
| -Single House | Shingles | Individual |
| Two family | Stucco | - Open |
| Three family | Paper | - Set tubs |
| Apartment | Tapestry Brick | Finish |
| Store Building | " | -Plain |
| Office | Galv. Iron | Hardwood |
| Factory | " | Halls |
| Storage | Terra Cotta | -Wood |
| Stables | Concrete | Terrazzo |
| Garage, private | | Marble |
| Garage, public | | Roof - Roofing |
| Theatre | Heating | -Shingle |
| Club House | Stove | Slate |
| Cottage | -Furnace | Gravel |
| | Hot Water | Prepared |
| Foundation | Steam | Asbestos |
| -Brick | | Flat |
| -Stone | Light | Hip |
| Concrete | Oil | - Gable |
| Pile | Gas | Dormers |
| | - Electric | Windows |
| Basement | | -Plain Glass |
| -Full | | Wire Glass |
| -Cement Floor | Floor | Shutters |
| Waterproof | -Common | Miscellaneous |
| | Hardwood | Elevator |
| Construction | Re-Concrete | Sprinkler |
| -Frame | Concrete Slab | Fire Escape |
| Brick | Waterproof | Refrigerator |
| Tile | | Vacuum Cleaner |
| Blocks | Ceiling | Safes and Vaults |
| Stucco | -Plaster | Telephone Equip. |
| Re-Concrete | Metal | |
| Mill | Panelled | |
| Steel Frame | Rough | |

Ground Area 855 Height 26
 Cubic Feet 22200 Unit 19 cts. 200
 Utility Dep. _____
 Dep. 35 Per cent.
 Sound Value, \$ 2601 2750 277

Land 20000 Corner _____ Interior _____ Alley _____
 Front _____ Depth _____ = _____ ft.
 COMPUTATION

Area	Multiplier	Coefficient	
20000	59	11800	
Year	Unit	Coefficient	Land Value
19	.10	11800	\$1180 <u>1175</u>



Surveyed by [Signature]
 JUN 24 1924
 (Remarks on other Side) 174
22-1088-196-11800+

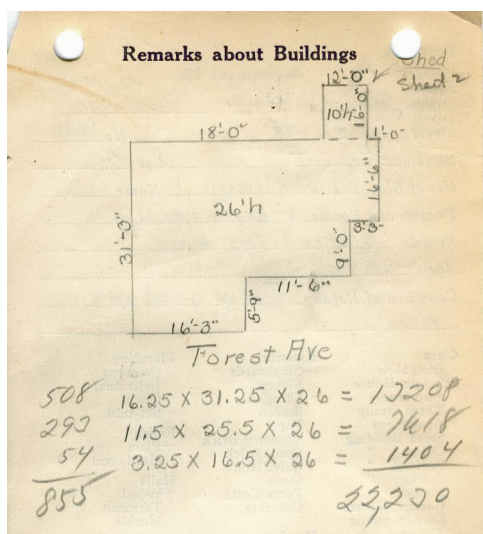

Remarks about Land

Remarks about Personal Property

CITY OF PORTLAND, MAINE
 ASSESSORS DEPARTMENT

CHART	BLOCK
3	Building Volumes Checked <u>SC</u>
4	Building Values Placed
5	Building Values Extended <u>SC</u>
6	Land Copy Questionnaire Made
7	Land Values Placed
8	Land Values Extended
9	Compared with 1923
10	Personal Property Added

1924 Portland Tax Records: 1335 Forest Avenue, Portland, 1924



Owner: Albion W. Shaw
Address: 1335 Forest Avenue, Riverton, Portland, Maine
Use: Dwelling - Single family
Local Code: Block 341A Lot 4 Book 38 Page 1
MMN item number: 55883