

1924 Portland Tax Records: 56-70 Danforth Street, Portland, 1924

Exempt #116

Portland, Maine

Assessment 19

Name Childrens Hospital Exempt
 Owner Danforth
 Street High No. 56-70
 Block 44 Lot 1

Use of Bldg. Hospital Name _____
 Tenants and Rooms Tenant
 Rentals Occupied by Owner
 Age 15 Yrs
 Condition of Repair Good
#68 High St

Class	Exterior	Plumbing
Bungalow	Clapboards	Common
Single House	Siding	Individual
Two family	Shingles	Open
Three family	Stucco	Set tubs
Apartment	Paper	
Store Building	Tapestry Brick	Finish
Office	Com. Brick	Plain
Factory	Galv. Iron	Hardwood
Storage	Stone	
Stables	Terra Cotta	Halls
Garage, private	Concrete	Wood
Garage, public		Terrazzo
Theatre		Marble
Club House	Heating	Roof - Roofing
Cottage	Stove	Shingle
<i>Hospital</i>	Furnace	Slate
Foundation	Hot Water	Gravel
Brick	Steam	Prepared
Stone		Asbestos
Concrete	Light	Flat
Pile	Oil	Hip
	Gas	Gable
Basement	Electric	Dormers
Full		Windows
Cement Floor	Floor	Plain Glass
Waterproof	Common	Wire Glass
	Hardwood	Shutters
Construction	Re-Concrete	Miscellaneous
Frame	Concrete Slab	Elevator
Brick	Waterproof	Sprinkler
Tile	<i>Marble chips</i>	Fire Escape
Blocks	Ceiling	Refrigerator
Stucco	Plaster	Vacuum Cleaner
Re-Concrete	Metal	Safes and Vaults
Mill	Paneled	Telephone Equip.
Steel Frame	Rough	

Ground Area 5,029 sq ft Height 46'
 Cubic Feet 254,647 Unit _____ cts.
 Utility Dep. _____
 Dep. _____ Per cent.

Sound Value, \$

Land 25184 Corner 23490 Interior _____ Alley _____
 Front 202 Depth 120 = _____ ft.

COMPUTATION

$13200 \times 94 \times .40 = 4963$
 $\frac{1}{4} \text{ of } 13200 \times 40 \text{ for corner} = 1320$
 $11884 \times 78 \times .40 = 3707$
9990

Area	Multiplier	Coefficient
<u>R 30-9,450</u>		

Year	Unit	Coefficient	Land Value
19			<u>29990</u>



Surveyed by T.F. Quincy
 (Remarks on other Side) 1186

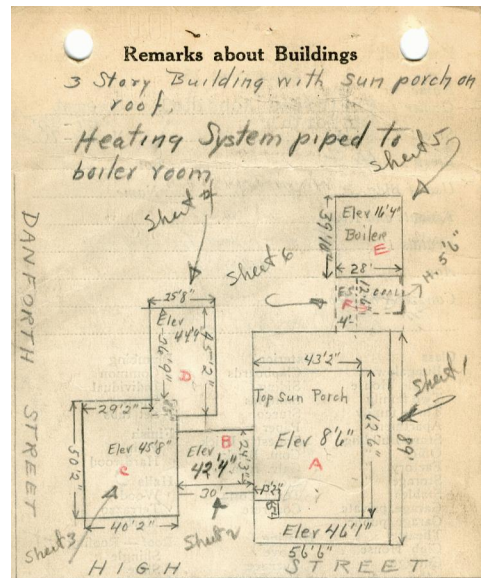

Remarks about Land

$56.5 \times 89 = 5028.50 \times 46.08 = 231,713.28$
 $43.17 \times 62.5 = 2698.13 \times 8.5 = 22,934.11$
5028.50 254,647.39

Remarks about Personal Property

Chart	Block
3	Building Volumes Checked
4	Building Values Placed
5	Building Values Extended
6	Land Only Questionnaire Made
7	Land Values Placed
8	Land Values Extended
9	Compared With 1923
10	Personal Property Added

ASSESSOR'S OFFICE

CHART _____ BLOCK _____

3	Building Volumes Checked	<input checked="" type="checkbox"/>
4	Building Values Placed	<input checked="" type="checkbox"/>
5	Building Values Extended	<input checked="" type="checkbox"/>
6	Land Only Questionnaire Made	<input type="checkbox"/>
7	Land Values Placed	<input type="checkbox"/>
8	Land Values Extended	<input type="checkbox"/>
9	Compared With 1923	<input type="checkbox"/>
10	Personal Property Added	<input type="checkbox"/>

1924 Portland Tax Records: 56-70 Danforth Street, Portland, 1924

www.maine-memory.net/item/57932
Collections of City of Portland - Planning & Development



Owner: Children's Hospital
Address: 56-70 Danforth Street, West End, Portland, Maine
Use: Hospital
Local Code: Block 44F Lot 1 Book 42 Page 1
MMN item number: 57932