

1924 Portland Tax Records: 190-192 High Street, Portland, 1924

L35001 #1162  
R10000

Portland, Maine  
Assessment 19

Name Shalit Annie R  
Owner Shalit Annie R  
Street High No. 190-192  
Block 46 B Lot 13  
Use of Bldg. Rooming House Name Shalit  
Tenants and Rooms 17 rooms + 3 bms  
Rentals \$125 Monthly  
Age Old  
Condition of Repair Fair

- |  |  |  |
|--|--|--|
| <b>Class</b>                                     | <b>Exterior</b>                                    | <b>Plumbing</b>                                      |
| <input checked="" type="checkbox"/> Bungalow     | <input checked="" type="checkbox"/> Clapboards     | <input checked="" type="checkbox"/> Common           |
| <input checked="" type="checkbox"/> Single House | <input checked="" type="checkbox"/> Siding         | <input checked="" type="checkbox"/> Individual       |
| <input type="checkbox"/> Two family              | <input checked="" type="checkbox"/> Shingles       | <input checked="" type="checkbox"/> Open             |
| <input type="checkbox"/> Three family            | <input checked="" type="checkbox"/> Stucco         | <input checked="" type="checkbox"/> Set tubs         |
| <input type="checkbox"/> Apartment               | <input checked="" type="checkbox"/> Paper          | <b>Finish</b>  |
| <input type="checkbox"/> Store Building          | <input checked="" type="checkbox"/> Tapestry Brick | <input checked="" type="checkbox"/> Plain            |
| <input type="checkbox"/> Office                  | <input checked="" type="checkbox"/> Com. Brick     | <input checked="" type="checkbox"/> Hardwood         |
| <input type="checkbox"/> Factory                 | <input checked="" type="checkbox"/> Galv. Iron     | <b>Halls</b>   |
| <input type="checkbox"/> Storage                 | <input checked="" type="checkbox"/> Stone          | <input checked="" type="checkbox"/> Wood             |
| <input type="checkbox"/> Stables                 | <input checked="" type="checkbox"/> Terra Cotta    | <input checked="" type="checkbox"/> Terrazzo         |
| <input type="checkbox"/> Garage, private         | <input checked="" type="checkbox"/> Concrete       | <input checked="" type="checkbox"/> Marble           |
| <input type="checkbox"/> Garage, public          |  |  |
| <input type="checkbox"/> Theatre                 | <b>Heating</b>                                     | <b>Roof - Roofing</b>                                |
| <input type="checkbox"/> Club House              | <input checked="" type="checkbox"/> Stove          | <input checked="" type="checkbox"/> Shingle          |
| <input type="checkbox"/> Cottage                 | <input checked="" type="checkbox"/> Furnace        | <input checked="" type="checkbox"/> Slate            |
|  | <input checked="" type="checkbox"/> Hot Water      | <input checked="" type="checkbox"/> Gravel           |
|  | <input checked="" type="checkbox"/> Steam          | <input checked="" type="checkbox"/> Prepared         |
| <b>Foundation</b>                                | <b>Light</b>                                       | <input checked="" type="checkbox"/> Asbestos         |
| <input checked="" type="checkbox"/> Brick        | <input checked="" type="checkbox"/> Oil            | <input checked="" type="checkbox"/> Flat             |
| <input checked="" type="checkbox"/> Stone        | <input checked="" type="checkbox"/> Gas            | <input checked="" type="checkbox"/> Hip              |
| <input checked="" type="checkbox"/> Concrete     | <input checked="" type="checkbox"/> Electric       | <input checked="" type="checkbox"/> Gable            |
| <input checked="" type="checkbox"/> Pile         |  | <input checked="" type="checkbox"/> Dormers          |
| <b>Basement</b>                                  | <b>Floor</b>                                       | <b>Windows</b>                                       |
| <input checked="" type="checkbox"/> Full         | <input checked="" type="checkbox"/> Common         | <input checked="" type="checkbox"/> Plain Glass      |
| <input checked="" type="checkbox"/> Cement Floor | <input checked="" type="checkbox"/> Hardwood       | <input checked="" type="checkbox"/> Wire Glass       |
| <input checked="" type="checkbox"/> Waterproof   | <input checked="" type="checkbox"/> Re-Concrete    | <input checked="" type="checkbox"/> Shutters         |
| <b>Construction</b>                              | <input checked="" type="checkbox"/> Concrete Slab  | <b>Miscellaneous</b>                                 |
| <input checked="" type="checkbox"/> Frame        | <input checked="" type="checkbox"/> Waterproof     | <input checked="" type="checkbox"/> Elevator         |
| <input checked="" type="checkbox"/> Brick        |  | <input checked="" type="checkbox"/> Sprinkler        |
| <input checked="" type="checkbox"/> Tile         | <b>Ceiling</b>                                     | <input checked="" type="checkbox"/> Fire Escape      |
| <input checked="" type="checkbox"/> Blocks       | <input checked="" type="checkbox"/> Plaster        | <input checked="" type="checkbox"/> Refrigerator     |
| <input checked="" type="checkbox"/> Stucco       | <input checked="" type="checkbox"/> Metal          | <input checked="" type="checkbox"/> Vacuum Cleaner   |
| <input checked="" type="checkbox"/> Re-Concrete  | <input checked="" type="checkbox"/> Panelled       | <input checked="" type="checkbox"/> Safes and Vaults |
| <input checked="" type="checkbox"/> Mill         | <input checked="" type="checkbox"/> Rough          | <input checked="" type="checkbox"/> Telephone Equip. |
| <input checked="" type="checkbox"/> Steel Frame  |  |  |

Ground Area 1458 Height.....  
Cubic Feet 53838 Unit 16 cts.  
Utility Dep. ....  
Dep. 50 Per cent.  
- Sound Value, \$ 4307

Land 5000 Corner..... Interior..... Alley.....  
Front 50 Depth 100 = ..... ft.  
COMPUTATION  
 $5000 \times 100 \times 125 = 6250$   
 $5000 \times 12 = 6000$   
 $6250 - 6000 = 250$   
 $250 + 400 = 650$

Area	Multiplier	Coefficient
		<u>\$6550</u>
Year	Unit	Coefficient
19		<u>6750</u>



Surveyed by J. M. ...  
(Remarks on other Side) May 5, 1924  
10/2

Remarks about Buildings

$50\frac{1}{2} \times 25\frac{1}{2} = 1288$      $\times 38\frac{1}{2} = 49588$   
 $17 \times 10 = 170$      $\times 25 = 4250$   
1458    53838

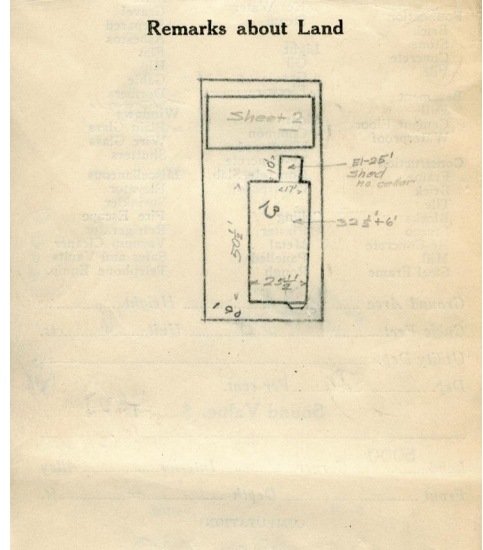

Remarks about Personal Property

CITY OF PORTLAND, MAINE  
ASSESSORS DEPARTMENT

CHART	BLOCK
3	Building Volumns Checked
4	Building Values Placed
5	Building Values Extended
6	Land City Questionnaire Made
7	Land Values Placed
8	Land Values Extended
9	
10	

1924 Portland Tax Records: 190-192 High Street, Portland, 1924

[www.maine-memory.net/item/58079](http://www.maine-memory.net/item/58079)  
Collections of City of Portland - Planning & Development



**Owner:** Annie R. Shalit  
**Address:** 190-192 High Street, West End, Portland, Maine  
**Use:** Rooming House  
**Local Code:** Block 46B Lot 13 Book 42 Page 1  
**MMN item number:** 58079