

1924 Portland Tax Records: 62 Jackson Street, Portland, 1924

Portland, Maine
 Assessment 19
 Name *Conadon Virginia K*
 Owner *Willey Bertram N*
 Street *Jackson* No. *62*
 Block *382-F-4* Lot
 Use of Bldg. *D* Name
 Tenants and Rooms *1-5*
 Rentals
 Age *6 years*
 Condition of Repair *good*

- | | | |
|---|--|--|
| Class | Exterior | Plumbing |
| <input checked="" type="checkbox"/> Bungalow | <input checked="" type="checkbox"/> Clapboards | <input checked="" type="checkbox"/> Common |
| <input checked="" type="checkbox"/> Single House | <input checked="" type="checkbox"/> Siding | <input checked="" type="checkbox"/> Individual |
| <input checked="" type="checkbox"/> Two family | <input checked="" type="checkbox"/> Shingles | <input checked="" type="checkbox"/> Open |
| <input checked="" type="checkbox"/> Three family | <input checked="" type="checkbox"/> Stucco | <input checked="" type="checkbox"/> Set tubs |
| <input checked="" type="checkbox"/> Apartment | <input checked="" type="checkbox"/> Paper | Finish |
| <input checked="" type="checkbox"/> Store Building | <input checked="" type="checkbox"/> Tapestry Brick | <input checked="" type="checkbox"/> Plain |
| <input checked="" type="checkbox"/> Office | <input checked="" type="checkbox"/> Com. Brick | <input checked="" type="checkbox"/> Hardwood |
| <input checked="" type="checkbox"/> Factory | <input checked="" type="checkbox"/> Galv. Iron | Halls |
| <input checked="" type="checkbox"/> Storage | <input checked="" type="checkbox"/> Stone | <input checked="" type="checkbox"/> Wood |
| <input checked="" type="checkbox"/> Stables | <input checked="" type="checkbox"/> Terra Cotta | <input checked="" type="checkbox"/> Terrazzo |
| <input checked="" type="checkbox"/> Garage, private | <input checked="" type="checkbox"/> Concrete | <input checked="" type="checkbox"/> Marble |
| <input checked="" type="checkbox"/> Theatre | Heating | Roof - Roofing |
| <input checked="" type="checkbox"/> Club House | <input checked="" type="checkbox"/> Stove | <input checked="" type="checkbox"/> Shingle |
| <input checked="" type="checkbox"/> Cottage | <input checked="" type="checkbox"/> Furnace | <input checked="" type="checkbox"/> Slate |
| | <input checked="" type="checkbox"/> Hot Water | <input checked="" type="checkbox"/> Gravel |
| Foundation | <input checked="" type="checkbox"/> Steam | <input checked="" type="checkbox"/> Prepared |
| <input checked="" type="checkbox"/> Brick | Light | <input checked="" type="checkbox"/> Asbestos |
| <input checked="" type="checkbox"/> Stone | <input checked="" type="checkbox"/> Oil | <input checked="" type="checkbox"/> Flat |
| <input checked="" type="checkbox"/> Concrete | <input checked="" type="checkbox"/> Gas | <input checked="" type="checkbox"/> Hip |
| <input checked="" type="checkbox"/> Pile | <input checked="" type="checkbox"/> Electric | <input checked="" type="checkbox"/> Gable |
| Basement | | <input checked="" type="checkbox"/> Dormers |
| <input checked="" type="checkbox"/> Full | Floor | Windows |
| <input checked="" type="checkbox"/> Cement Floor | <input checked="" type="checkbox"/> Common | <input checked="" type="checkbox"/> Plain Glass |
| <input checked="" type="checkbox"/> Waterproof | <input checked="" type="checkbox"/> Hardwood | <input checked="" type="checkbox"/> Wire Glass |
| | <input checked="" type="checkbox"/> Re-Concrete | <input checked="" type="checkbox"/> Shutters |
| Construction | <input checked="" type="checkbox"/> Concrete Slab | Miscellaneous |
| <input checked="" type="checkbox"/> Frame | <input checked="" type="checkbox"/> Waterproof | <input checked="" type="checkbox"/> Elevator |
| <input checked="" type="checkbox"/> Brick | Ceiling | <input checked="" type="checkbox"/> Sprinkler |
| <input checked="" type="checkbox"/> Tile | <input checked="" type="checkbox"/> Plaster | <input checked="" type="checkbox"/> Fire Escape |
| <input checked="" type="checkbox"/> Blocks | <input checked="" type="checkbox"/> Metal | <input checked="" type="checkbox"/> Refrigerator |
| <input checked="" type="checkbox"/> Stucco | <input checked="" type="checkbox"/> Panelled | <input checked="" type="checkbox"/> Vacuum Cleaner |
| <input checked="" type="checkbox"/> Re-Concrete | <input checked="" type="checkbox"/> Rough | <input checked="" type="checkbox"/> Safes and Vaults |
| <input checked="" type="checkbox"/> Mill | | <input checked="" type="checkbox"/> Telephone Equip. |
| <input checked="" type="checkbox"/> Steel Frame | | |

Ground Area *624* Height *20*
 Cubic Feet *12480* Unit *40* cts.
 Utility Dep.
 Dep. *25* Per cent.
Sound Value, \$ 1872

Land *9750* Corner *10225* Interior *10579* Alley
 Front *10579* Depth *20* = *20* ft.

COMPUTATION
H-1900
10225
10579
20

Area	Multiplier	Coefficient	
10225	69	7055	
Year	Unit	Coefficient	Land Value
19	.03	7055	211 <i>4200</i>



Surveyed by *G. W. Ferry*
 (Remarks on other Side)
1924-1143-251-3500+

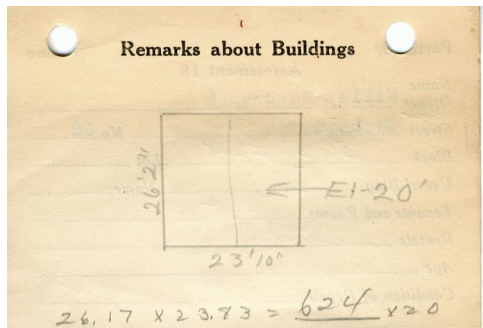

12480

Remarks about Land

Remarks about Personal Property

CITY OF PORTLAND, MAINE
 ASSESSORS DEPARTMENT

CHART	BLOCK
3 Building Volume Checked	
4 Building Values Placed	<i>30</i>
5 Building Values Extended	
6 Land Only Questionnaire Made	<i>8. M. H.</i>
7 Land Values Placed	
8 Land Values Extended	
9 compared with 1923	
10 General Property Added	

1924 Portland Tax Records: 62 Jackson Street, Portland, 1924

www.maine-memory.net/item/58740
Collections of City of Portland - Planning & Development



Owner: Bertram N. Willey
Address: 62 Jackson Street, North Deering, Portland, Maine
Use: Bungalow
Local Code: Block 382F Lot 4 Book 44 Page 1
MMN item number: 58740
Notes: The property was subsequently owned by Virginia R. Congdon.