

# 1924 Portland Tax Records: Assessor's Record, 34-36 Lafayette Street, Portland, 1924

3-3

Portland, *Universal Laundry Inc.* Maine  
Assessment 19

Name *Thomas Charles E. Est*  
Owner *Thomas Charles E. Est*  
Street *Lafayette St* No. *34-36*  
Block *182A* Lot *171*  
Use of Bldg. *Covered Driveway* Name  
Tenants and Rooms  
Rentals *Owner*  
Age *Old*  
Condition of Repair *poor*

**Class**  
Bungalow  
Single House  
Two family  
Three family  
Apartment  
Store Building  
Office  
Factory  
Storage  
Stables  
Garage, private  
Garage, public  
Theatre  
Club House  
Cottage

**Foundation**  
Brick  
Stone  
Concrete  
Pile

**Basement**  
Full  
Cement Floor  
Waterproof

**Construction**  
Frame  
Brick  
Tile  
Blocks  
Stucco  
Re-Concrete  
Mill  
Steel Frame

**Exterior**  
Clapboards  
Siding  
Shingles  
Stucco  
Paper  
Tapestry Brick  
Com. Brick  
Galv. Iron  
Stone  
Terra Cotta  
Concrete

**Heating**  
Stove  
Furnace  
Hot Water  
Steam

**Light**  
Oil  
Gas  
Electric

**Floor**  
Common  
Hardwood  
Re-Concrete  
Concrete Slab  
Waterproof

**Ceiling**  
Plaster  
Metal  
Panelled  
Rough

**Plumbing**  
Common  
Individual  
Open  
Set tubs

**Finish**  
Plain  
Hardwood

**Halls**  
Wood  
Terrazzo  
Marble

**Roof — Roofing**  
Shingle  
Slate  
Gravel  
Prepared  
Asbestos  
Flat  
Hip  
Gable  
Dormers

**Windows**  
Plain Glass  
Wire Glass  
Shutters

**Miscellaneous**  
Elevator  
Sprinkler  
Fire Escape  
Refrigerator  
Vacuum Cleaner  
Safes and Vaults  
Telephone Equip.

Ground Area *685* Height *10*  
Cubic Feet *6850* Unit *10*  
Utility Dep. *137*  
Dep. *70.80* Per cent. *137*  
Sound Value, \$ *206*  
*(125) 206*

Land Corner Interior Alley  
Front Depth = ft.  
COMPUTATION

Area	Multiplier	Coefficient

Year	Unit	Coefficient	Land Value
19			

**Personal Property** Value

Animals No. \$  
" " "  
" " "  
Dogs, Male Female  
Auto Year  
" "  
Furniture Good Common  
Musical Inst. Good Common  
Carriages Good No. Common  
Other Personal Property  
Surveyed by  
(Remarks on other Side)

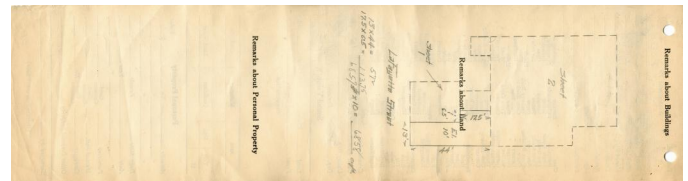

## 1924 Portland Tax Records: Assessor's Record, 34-36 Lafayette Street, Portland, 1924

**Owner:** Estate of Charles E. Thomas  
**Address:** 34-36 Lafayette Street, East End - Munjoy Hill, Portland, Maine  
**Use:** Garage  
**Local Code:** Block 14A Lot 17 Book 45 Page 3  
**MMN item number:** 59946