

1924 Portland Tax Records: 10 Lassell Street, Portland, 1924

Portland, Maine
 Assessment 19 lot 16
 Name Owner Oliver Horace W.
 Street Lassell No. 10-12
 Block 191A Lot 11
 Use of Bldg. Name
 Tenants and Rooms
 Rentals
 Age
 Condition of Repair

- | | | |
|---------------------|-----------------|-----------------------|
| Class | Exterior | Plumbing |
| Bungalow | Clapboards | Common |
| Single House | Siding | Individual |
| Two family | Shingles | Open |
| Three family | Stucco | Set tubs |
| Apartment | Paper | Finish |
| Store Building | Tapestry Brick | Plain |
| Office " | Com. Brick | Hardwood |
| Factory " | Galv. Iron | Halls |
| Storage | Stone | Wood |
| Stables | Terra Cotta | Terrazzo |
| Garage, private | Concrete | Marble |
| Garage, public | | Roof - Roofing |
| Theatre | Heating | Shingle |
| Club House | Stove | Slate |
| Cottage | Furnace | Gravel |
| | Hot Water | Prepared |
| Foundation | Steam | Asbestos |
| Brick | Light | Flat |
| Stone | Oil | Hip |
| Concrete | Gas | Gable |
| Pile | Electric | Dormers |
| Basement | | Windows |
| Full | Floor | Plain Glass |
| Cement Floor | Common | Wire Glass |
| Waterproof | Hardwood | Shutters |
| Construction | Re-Concrete | Miscellaneous |
| Frame | Concrete Slab | Elevator |
| Brick | Waterproof | Sprinkler |
| Tile | Ceiling | Fire Escape |
| Blocks | Plaster | Refrigerator |
| Stucco | Metal | Vacuum Cleaner |
| Re-Concrete | Panelled | Safes and Vaults |
| Mill | Rough | Telephone Equip. |
| Steel Frame | | |

Ground Area 5355 sq ft Height 22
 Cubic Feet 11776 Unit 26
 Utility Dep.
 Dep. 15 Per cent.
 Sound Value, \$ 2000

Land 5800 Corner Interior Alley
 Front Depth = ft.

COMPUTATION
 scales 5800 # raised 1908

Area	Multiplier	Coefficient	
5800	100	5800	
Year	Unit	Coefficient	Land Value
19	.06	5800	\$ 348

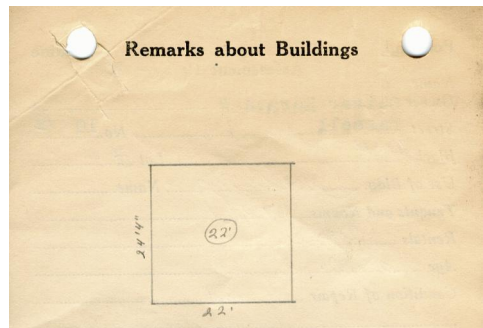

$22 \times 24.33 = 535.26$
 $535.26 \times 22 = 11775.72$

Remarks about Land

Remarks about Personal Property

CITY OF PORTLAND, MAINE
 ASSESSORS DEPARTMENT

CHART	BLOCK
3	Building Volumes Checked 1922
4	Building Values Placed 1922
5	Building Values Extended
6	Land Only Questionnaire Made
7	Land Values Placed
8	Land Values Extended
9	Compared With 1923
10	Personal Property Added

1924 Portland Tax Records: 10 Lassell Street, Portland, 1924

www.maine-memory.net/item/60343
Collections of City of Portland - Planning & Development



Owner: Horace W. Oliver
Address: 10 Lassell Street, Libbytown, Portland, Maine
Use: Dwelling - Single family
Local Code: Block 191A Lot 11 Book 46 Page 1
MMN item number: 60343