

1924 Portland Tax Records: 28 Locust Street, Portland, 1924

Portland, Maine
 Assessment 1924
 Name Roman Cath. Bishop of Portland
 Street Locust No. 28
 Cumberland Ave Lot 12 172-174
 Use of Bldg. Street Dwelling Name
 Tenants and Rooms 5 1-6-8-9 Kts.
 Rentals 150.00 150.00 150.00
 Age 45 Years
 Condition of Repair Exterior Poor Interior Poor

Class	Exterior	Plumbing
Bungalow	Clapboards	Common
Single House	Siding	Individual
Two family	Shingles	Open
Three family	Stucco	Set tubs 2
Apartment	Paper	Finish
Store Building	Tapestry Brick	Plain
Office	Com. Brick	Hardwood
Factory	Galv. Iron	Halls
Storage	Stone	Wood
Stables	Terra Cotta	Terrazzo
Garage, private	Concrete	Marble
Garage, public	Heating	Roof - Roofing
Theatre	Stove	Shingle
Club House	Furnace	Slate
Cottage	Hot Water	Gravel
Foundation	Steam	Prepared
Brick	Light	Asbestos
Stone	Oil	Flat
Concrete	Gas	Hip
Pile	Electric	Gable
Basement		Dormers
Full		Windows
Cement Floor	Floor	Plain Glass
Waterproof	Common	Wire Glass
Construction	Hardwood	Shutters
Frame	Re-Concrete	Miscellaneous
Brick	Concrete Slab	Elevator
Tile	Waterproof	Sprinkler
Blocks	Ceiling	Fire Escape
Stucco	Plaster	Refrigerator
Re-Concrete	Metal	Vacuum Cleaner
Mill	Panelled	Safes and Vaults
Steel Frame	Rough	Telephone Equip.

Ground Area 1795 Height 32'-21" 50
 Cubic Feet 41850 Unit 16 cts.
 Utility Dep.
 Dep. 60 Per cent.
 Sound Value, \$ 2678

Land 1300 Corner Interior Alley
 Front Depth = ft.
 COMPUTATION
 $1045 \times 139 = 145255$
 $1197 \times 40 = 47880$
 $1045 \times 35 = 36575$
 $4/1197 \times 40 = 19160$
 $255 \times 118 \times 40 = 1203600$
 782 68251

Area	Multiplier	Coefficient
		# 650
Year	Unit	Coefficient
19		Land Value 782



Surveyed by
 (Remarks on other Side)

Remarks about Buildings
 FALL GABLE ROOF PRE ROOFING

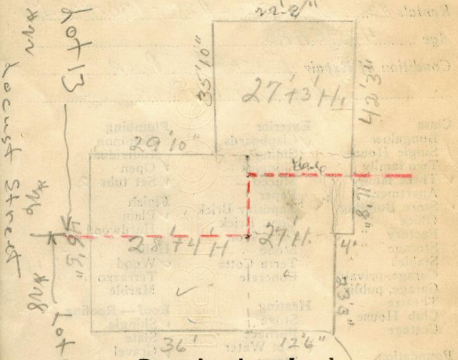

Remarks about Land
 FLAT ROOF GRAVELY TAA

36 x 23.25 = 837 x 32 = 26784
 19.5 x 23.25 = 291 x 27 = 2857
 16.67 x 4 = 67 x 27 = 1809
 14.67 x 12 = 200 x 900 = 5400
 1795 41850

Remarks about Personal Property

CITY OF PORTLAND, MAINE
 ACCESSORS DEPARTMENT

CHART	BLOCK
3 Building Volumes Checked	172
4 Building Values Placed	172
5 Building Values Extended	172
6 Land Only Questionnaire Made	
7 Land Values Placed	
8 Land Values Extended	
9 Compared with 1923	
10 Personal Property Added	

1924 Portland Tax Records: 28 Locust Street, Portland, 1924

www.maine-memory.net/item/61396
Collections of City of Portland - Planning & Development

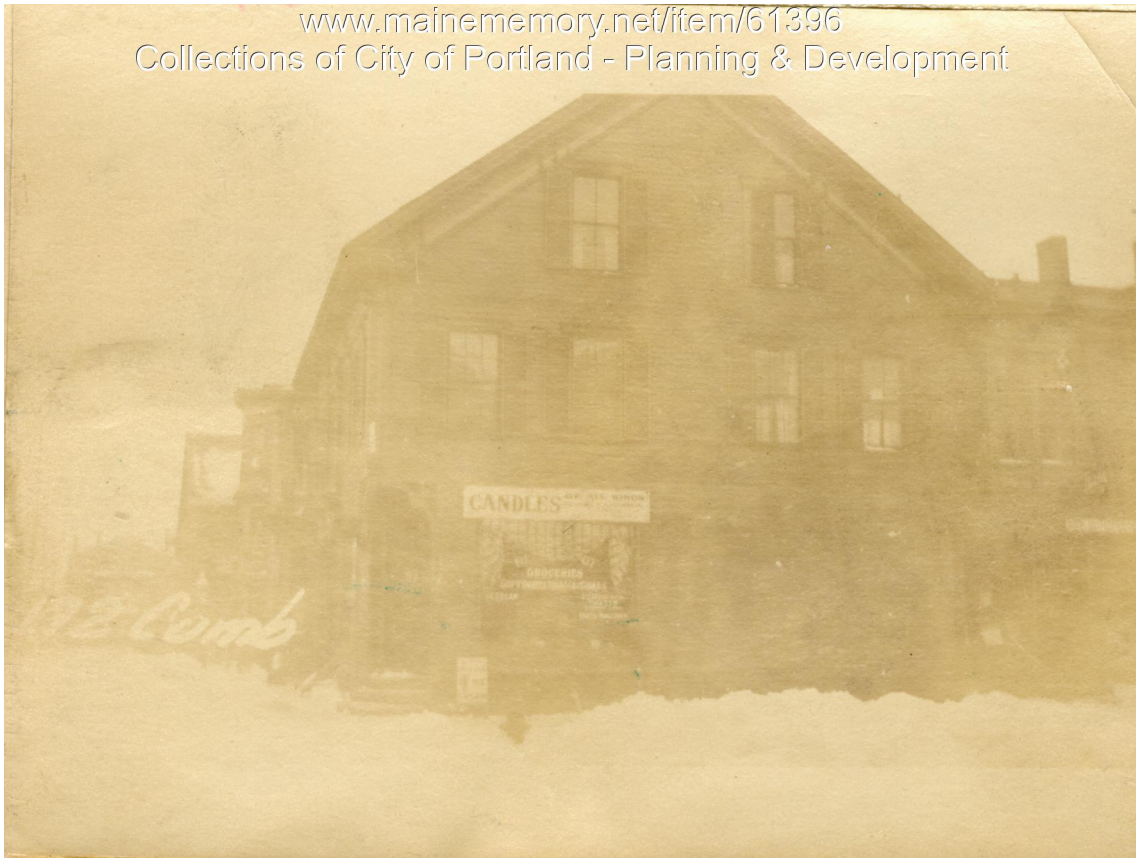

Owner: Roman Catholic Bishop of Portland
Address: 28 Locust Street, East End, Portland, Maine
Use: Dwelling - Three Family & Store
Local Code: Block 21D Lot 12 Book 47 Page 1
MMN item number: 61396