

1924 Portland Tax Records: 180 Longfellow Street, Portland, 1924

L250
B3800

Portland, Maine

Assessment 19

Name Shurtleff Caroline R

Owner Shurtleff Caroline R

Street Longfellow No. 180

Block 119 Lot 2

Use of Bldg. DWELLING Name

Tenants and Rooms 1 - 7 ROOMS

Rentals HOME-OWNER

Age 7 YEARS

Condition of Repair EXTERIOR GOOD
INTERIOR GOOD

<input checked="" type="checkbox"/> Bungalow	Exterior	Plumbing
<input checked="" type="checkbox"/> Single House	Clapboards	Common
<input checked="" type="checkbox"/> Two family	Siding	Individual
<input checked="" type="checkbox"/> Three family	Shingles	Open
<input checked="" type="checkbox"/> Apartment	Stucco	Set tubs
<input checked="" type="checkbox"/> Store Building	Paper	Finish
<input checked="" type="checkbox"/> Office	Tapestry Brick	Plain
<input checked="" type="checkbox"/> Factory	Com. Brick	Hardwood
<input checked="" type="checkbox"/> Storage	Galv. Iron	Halls
<input checked="" type="checkbox"/> Stables	Stone	Wood
<input checked="" type="checkbox"/> Garage, private	Terra Cotta	Terrazzo
<input checked="" type="checkbox"/> Garage, public	Concrete	Marble
<input checked="" type="checkbox"/> Theatre	Heating	Roof - Roofing
<input checked="" type="checkbox"/> Club House	Stove	Shingle
<input checked="" type="checkbox"/> Cottage	Furnace	Slate
	Hot Water	Gravel
	Steam	Prepared
Foundation	Light	Asbestos
<input checked="" type="checkbox"/> Brick	Oil	Flat
<input checked="" type="checkbox"/> Stone	Gas	Hip
<input checked="" type="checkbox"/> Concrete	Electric	Gable
<input checked="" type="checkbox"/> Pile		Dormers
Basement	Floor	Windows
<input checked="" type="checkbox"/> Full	Common	Plain Glass
<input checked="" type="checkbox"/> Cement Floor	Hardwood	Wire Glass
<input checked="" type="checkbox"/> Waterproof	Re-Concrete	Shutters
Construction	Concrete Slab	Miscellaneous
<input checked="" type="checkbox"/> Frame	Waterproof	Elevator
<input checked="" type="checkbox"/> Brick		Sprinkler
<input checked="" type="checkbox"/> Tile	Ceiling	Fire Escape
<input checked="" type="checkbox"/> Blocks	Plaster	Refrigerator
<input checked="" type="checkbox"/> Stucco	Metal	Vacuum Cleaner
<input checked="" type="checkbox"/> Re-Concrete	Panelled	Safes and Vaults
<input checked="" type="checkbox"/> Mill	Rough	Telephone Equip.
<input checked="" type="checkbox"/> Steel Frame		

Ground Area 12,018 sq ft Height 23'4"

Cubic Feet 273,229 Unit 10 cts

Utility Dep. _____

Dep. 0 Per cent.

Sound Value, \$ 5468
(5475)

Land 7000 Corner _____ Interior _____ Alley _____

Front _____ Depth _____ = _____ ft.

COMPUTATION

Area	Multiplier	Coefficient	
7000	84	5880	
Year	Unit	Coefficient	Land Value
19	422	5880	1293



Surveyed by Geo. S. D. ...

(Remarks on other Side)

1922-11-21-425-13500 1-2

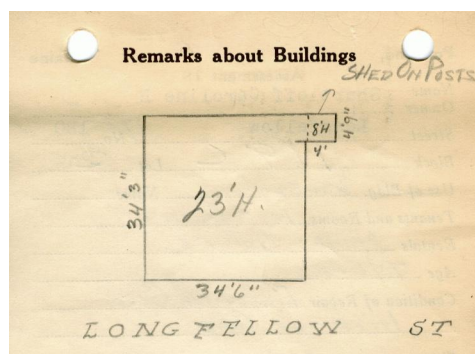

34.5 X 34.25 X 23 =
4 X 4.75 X 8 =

Remarks about Land

1181.62 X 23 = 27177.26
19. - X 8 = 152. -

1200.62 27329.26

Remarks about Personal Property

CITY OF PORTLAND, MAINE		
ASSESSORS DEPARTMENT		
CHART	BLOCK	
3	Building Volums Checked	<u>204</u>
4	Building Values Placed	<u>1104</u>
5	Building Values Extended	
6	Land Only Questionnaire Made	
7	Land Values Placed	
8	Land Values Extended	
9	Compared With 1923	
10	Personal Property Added	

1924 Portland Tax Records: 180 Longfellow Street, Portland, 1924

www.maine-memory.net/ftem/61661
Collections of City of Portland - Planning & Development



Owner: Caroline R. Shurtleff
Address: 180 Longfellow Street, Oakdale, Portland, Maine
Use: Dwelling - Single family
Local Code: Block 119C Lot 2 Book 47 Page 1
MMN item number: 61661