

1924 Portland Tax Records: 9 Moody Street, Portland, 1924

Portland, Maine
 Assessment 1924
 Name Owner Towle, Susan E & Gertrude E
 Street Moody No. 9
 Block 3 Lot 16
 Use of Bldg. Dwelling Name
 Tenants and Rooms General Rooms 6-9
 Rentals
 Age 35
 Condition of Repair Good

- | | | |
|---------------------|-----------------|-----------------------|
| Class | Exterior | Plumbing |
| Bungalow | Clapboards | Common |
| Single House | Siding | Individual |
| Two family | Shingles | Open |
| Three family | Stucco | Set tubs |
| Apartment | Paper | Finish |
| Store Building | Tapestry Brick | Plain |
| Office | Com. Brick | Hardwood |
| Factory | Galv. Iron | Halls |
| Storage | Stone | Wood |
| Stables | Terra Cotta | Terrazzo |
| Garage, private | Concrete | Marble |
| Garage, public | | Roof - Roofing |
| Theatre | Heating | Shingle |
| Club House | Stove | Slate |
| Cottage | Furnace | Gravel |
| | Hot Water | Prepared |
| | Steam | Asbestos |
| Foundation | Light | Flat |
| Brick | Oil | Hip |
| Stone | Gas | Gable |
| Concrete | Electric | Dormers |
| Pile | | Windows |
| Basement | | Plain Glass |
| Full | | Wire Glass |
| Cement Floor | | Shutters |
| Waterproof | | Miscellaneous |
| Construction | Floor | Elevator |
| Frame | Common | Sprinkler |
| Brick | Hardwood | Fire Escape |
| Tile | Re-Concrete | Refrigerator |
| Blocks | Concrete Slab | Vacuum Cleaner |
| Stucco | Waterproof | Safes and Vaults |
| Re-Concrete | | Telephone Equip. |
| Mill | Ceiling | |
| Steel Frame | Plaster | |
| | Metal | |
| | Paneled | |
| | Rough | |

Ground Area 1631 Height 35'
 Cubic Feet 57095 Unit 16 cts
 Utility Dep.
 Dep. 55 Per cent.
 Sound Value, \$ 4110.90

Land 3200 Corner 3214 Interior Alley
 Front Depth = ft.
 COMPUTATION

Area	Multiplier	Coefficient	
3214		3856	
3200	120	3840	
Year	Unit	Coefficient	Land Value
19	1/8	3840	671

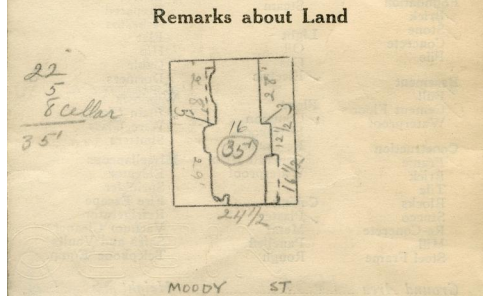
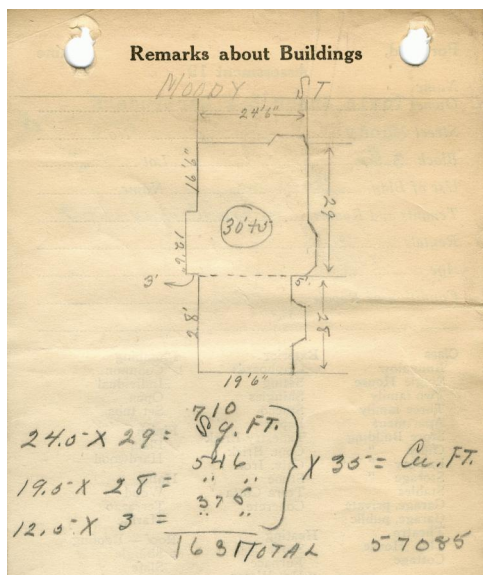
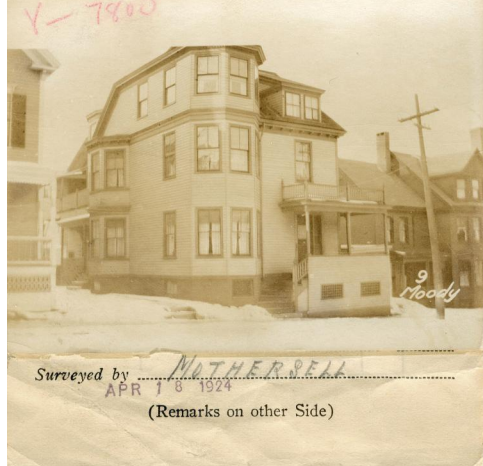

Remarks about Personal Property

CITY OF PORTLAND, MAINE
 ASSESSORS DEPARTMENT

CHART	BLOCK
3	Building Volumes Checked RD
4	Building Values Placed
5	Building Values Extended PER
6	Land Only Questionnaire Made
7	Land Values Placed
8	Land Values Extended
9	Compared with 1923
10	Personal Property Added

1924 Portland Tax Records: 9 Moody Street, Portland, 1924



Owner: Susan E. Towle
Address: 9 Moody Street, East End - Munjoy Hill, Portland, Maine
Use: Dwelling - Two family
Local Code: Block 3A Lot 16 Book 51 Page 1
MMN item number: 63662
Notes: The property was also owned by Gertrude E. Towle.