

1924 Portland Tax Records: 33-37 Montreal Street, Portland, 1924

L-700  
B-2000

Portland, Maine  
Assessment 19

Name Connolly Bartley A  
 Owner Montreal 33-37  
 Street Willis No. 15-21  
 Block 15 B Lot 15  
 Use of Bldg. Dwelling Name.....  
 Tenants and Rooms 2 ten - 1 in here  
 Rentals Occupied by owner  
 Age 20 yrs  
 Condition of Repair Poor

<b>Class</b> Bungalow Single House Two family Three family Apartment Store Building Office " Factory " Storage " Stables Garage, private Garage, public Theatre Club House Cottage	<b>Exterior</b> Clapboards Siding Shingles Stucco Paper Tapestry Brick Com. Brick Galv. Iron Stone Terra Cotta Concrete	<b>Plumbing</b> Common Individual Open Set tubs
<b>Foundation</b> Brick Stone Concrete Pile	<b>Heating</b> Stove Furnace Hot Water Steam	<b>Finish</b> Plain Hardwood
<b>Basement</b> Full Cement Floor Waterproof	<b>Light</b> Oil Gas Electric	<b>Halls</b> Wood Terrazzo Marble
<b>Construction</b> Frame Brick Tile Blocks Stucco Re-Concrete Mill Steel Frame	<b>Floor</b> Common Hardwood Re-Concrete Concrete Slab Waterproof	<b>Roof - Roofing</b> Shingle Slate Gravel Prepared Asbestos Flat Hip Gable Dormers
	<b>Waterproof</b> Plaster Metal Panelled Rough	<b>Windows</b> Plain Glass Wire Glass Shutters
		<b>Miscellaneous</b> Elevator Sprinkler Fire Escape Refrigerator Vacuum Cleaner Safes and Vaults Telephone Equip.

Ground Area 1073.5 Height 28  
 Cubic Feet 35,409 Unit 18 1800  
 Utility Dep. 60 Per cent.  
 Dep. 60 Per cent.  
 Sound Value, \$ 2549

Land 7167 Corner..... Interior..... Alley.....  
 Front..... Depth..... =..... ft.  
 (745) COMPUTATION  
 $7167 \times 104 \times 10 = 745$   
 $7167 \times 10 = 89$   
 $89 \times 10 = 834$

Area	Multiplier	Coefficient

Year	Unit	Coefficient	Land Value
19			<u>834</u>

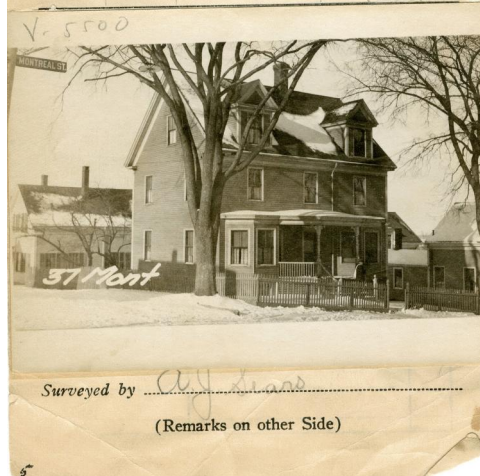

Remarks about Buildings

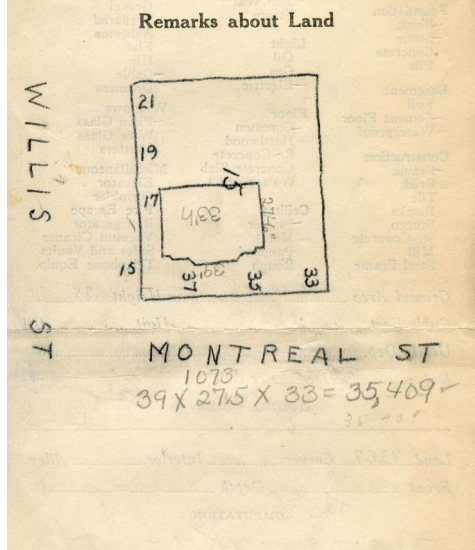

Remarks about Personal Property

CITY OF PORTLAND, MAINE		
ASSESSORS DEPARTMENT		
CHART	BLOCK	
3	Building Volumns Checked	<u>119, 192</u>
4	Building Values Placed	
5	Building Values Extended	<u>1116</u>
6	Land Only Questionnaire Made	
7	Land Values Placed	
8	Land Values Extended	
9	Compared With 1923	
10	Personal Property Added	

1924 Portland Tax Records: 33-37 Montreal Street, Portland, 1924



**Owner:** Bartley A. Connolly  
**Address:** 33-37 Montreal Street, East End - Munjoy Hill, Portland, Maine  
**Use:** Dwelling - Single family  
**Local Code:** Block 15B Lot 15 Book 51 Page 1  
**MMN item number:** 63893