

1924 Portland Tax Records: 5 Monument Street, Portland, 1924

Portland, Maine
 Assessment 19
 Name: Rothchild Mary
 Owner: Rothchild Mary
 Street: Monument (called 3) No. 5
 Block: 16 A Lot: 5
 Use of Bldg.: D Name: _____
 Tenants and Rooms: 2 Rooms 3-4-5
 Rentals: 46 MONTHLY TOTAL
 Age: Old
 Condition of Repair: POOR

- | | | |
|---------------------|-----------------|-----------------------|
| Class | Exterior | Plumbing |
| Bungalow | Clapboards | Common |
| Single House | Siding | Individual |
| Two family | Shingles | Open |
| Three family | Stucco | Set tubs |
| Apartment | Paper | Finish |
| Store Building | Tapestry Brick | Plain |
| Office | Com. Brick | Hardwood |
| Factory " | Galv. Iron | |
| Storage " | Stone | Halls |
| Stables | Terra Cotta | Wood |
| Garage, private | Concrete | Terrazzo |
| Garage, public | | Marble |
| Theatre | Heating | Roof - Roofing |
| Club House | Stove | Shingle |
| Cottage | Furnace | Slate |
| | Hot Water | Gravel |
| Foundation | Steam | Prepared |
| Brick | | Asbestos |
| Stone | Light | Flat |
| Concrete | Oil | Hip |
| File | Gas | Gable |
| | Electric | Dormers |
| Basement | | Windows |
| Full | | Plain Glass |
| Cement Floor | Floor | Wire Glass |
| Waterproof | Common | Shutters |
| | Hardwood | Miscellaneous |
| Construction | Re-Concrete | Elevator |
| Frame | Concrete Slab | Sprinkler |
| Brick | Waterproof | Fire Escape |
| Tile | | Refrigerator |
| Blocks | Ceiling | Vacuum Cleaner |
| Stucco | Plaster | Safes and Vaults |
| Re-Concrete | Metal | Telephone Equip. |
| Mill | Panelled | |
| Steel Frame | Rough | |

Ground Area: 10.93 Height: 91.25
 Cubic Feet: 32011 Unit: 16 cts.
 Utility Dep.: _____
 Dep.: 50 Per cent.
Sound Value, \$ 2561
 Land: 4000 Corner: _____ Interior: _____ Alley: _____
 Front: _____ Depth: _____ = _____ ft.
 COMPUTATION

Area	Multiplier	Coefficient	
4000	100	4000	
Year	Unit	Coefficient	Land Value
19	1/8		\$ 720



Surveyed by: [Signature]
 MAY 31 1924
 (Remarks on other Side)
 23 1104-453 3500-4000 1-2

Remarks about Buildings
MONUMENT ST

22' x 35.5 = 781
 19.5 x 16 = 312
 19.5 x 25 = 487.5
 781 + 312 = 1093
 487.5 + 32011 = 32500

Remarks about Land

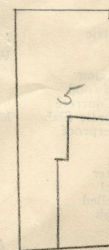

MONUMENT ST.

Remarks about Personal Property

CITY OF PORTLAND, MAINE
 ASSESSORS DEPARTMENT

CHART	BLOCK
3	Building Columns Checked
4	Building Values Placed
5	Building Values Extended
6	Land City Questionnaire Made
7	Land Values Placed
8	Land Values Extended
9	Compared With 1923
10	Personal Property Added

1924 Portland Tax Records: 5 Monument Street, Portland, 1924



Owner: Mary Rothchild
Address: 5 Monument Street, East End - Munjoy Hill, Portland, Maine
Use: Dwelling - Three Family
Local Code: Block 16A Lot 5 Book 52 Page 1
MMN item number: 63911