

1924 Portland Tax Records: 63-67 Newton Street, Portland, 1924

Portland, Maine  
 Assessment 19 <sup>L125</sup> <sup>B3000</sup>  
 Name Terrill Geo. W.  
 Owner Whipple William H  
 Street Newton Lots - 29-40 No. 63-67  
 Block Lexington Ave 338A Lot 6 & 7  
 Use of Bldg. Dwelling Name.....  
 Tenants and Rooms 1 - 12 Bms  
 Rentals None  
 Age 2 yrs  
 Condition of Repair Good

- |                 |                  |                  |
|-----------------|------------------|------------------|
| Class           | Exterior         | Plumbing         |
| Bungalow        | > Clapboards     | Common           |
| Single House    | > Siding         | Individual       |
| Two family      | > Shingles       | > Open           |
| Three family    | > Stucco         | Set tubs         |
| Apartment       | > Paper          | Finish           |
| Store Building  | > Tapestry Brick | > Plain          |
| Office "        | > Com. Brick     | > Hardwood       |
| Factory "       | > Galv. Iron     | Halls            |
| Storage "       | > Stone          | > Wood           |
| Stables         | > Terra Cotta    | > Terrazzo       |
| Garage, private | > Concrete       | Marble           |
| Garage, public  | Heating          | Roof - Roofing   |
| Theatre         | > Stove          | > Shingle        |
| Club House      | > Furnace        | Slate            |
| Cottage         | > Hot Water      | Gravel           |
|                 | > Steam          | Prepared         |
| Foundation      | Light            | Asbestos         |
| > Brick         | > Oil            | Flat             |
| > Stone         | > Gas            | Hip              |
| > Concrete      | > Electric       | Gable            |
| > Pile          |                  | Dormers          |
| Basement        | Floor            | Windows          |
| > Full          | > Common         | > Plain Glass    |
| > Cement Floor  | > Hardwood       | Wire Glass       |
| > Waterproof    | > Re-Concrete    | Shutters         |
| Construction    | > Concrete Slab  | Miscellaneous    |
| > Frame         | > Waterproof     | Elevator         |
| > Brick         | Ceiling          | Sprinkler        |
| > Tile          | > Plaster        | Fire Escape      |
| > Blocks        | > Metal          | Refrigerator     |
| > Stucco        | > Panelled       | Vacuum Cleaner   |
| > Re-Concrete   | > Rough          | Safts and Vaults |
| > Mill          |                  | Telephone Equip. |
| > Steel Frame   |                  |                  |

Ground Area 680 sq ft Height 21'  
 Cubic Feet 14280 Unit 2400  
 Utility Dep. ....  
 Dep. 1.5 Per cent.  
**Sound Value, \$2428**

Land 6500 Corner..... Interior..... Alley.....  
 Front..... Depth..... =..... ft.  
 COMPUTATION  
 $6500 \times 100 \times 0.15 = 97$   
 $6500 \times 0.15 = 12$   
 $\frac{97}{12} = 109$

Area	Multiplier	Coefficient
Year	Unit	Coefficient
19		\$109



Surveyed by W. H. ...  
 JUN 2 1924  
 (Remarks on other Side) 172  
 '25 - 1125/440 - 32604  
 '25 - 1165/428 - 43994

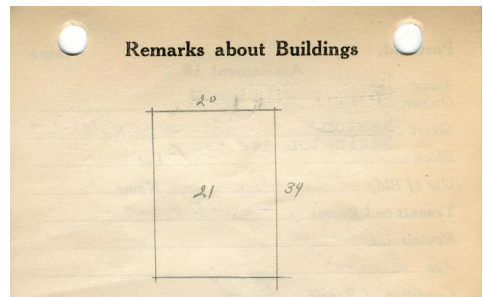

20 x 34 = 7 x 21 = CF  
 680 x 21 = 14280

Remarks about Land

Remarks about Personal Property

NOTICE OF PORTLAND, MAINE  
 ASSESSORS DEPARTMENT

CHART	BLOCK
3	Building Volumes Checked <u>#6H</u>
4	Building Values Placed <u>#6H</u>
5	Building Values Extended
6	Land Only Questionnaire Made
7	Land Values Placed
8	Land Values Extended
9	or parcels with 1923
10	Form of Property Added

1924 Portland Tax Records: 63-67 Newton Street, Portland, 1924

[www.majmemory.net/item/65569](http://www.majmemory.net/item/65569)  
Collections of City of Portland - Planning & Development



**Owner:** William H. Whipple  
**Address:** 63-67 Newton Street, Riverton, Portland, Maine  
**Use:** Dwelling - Single family  
**Local Code:** Block 338A Lot 6 Book 54 Page 1  
**MMN item number:** 65569  
**Notes:** The property was subsequently owned by George W. Terrill.