

1924 Portland Tax Records: 1-11 Noyes Street, Portland, 1924

Portland, Maine
 Assessment 19
 Name
 Owner Harmon Herbert A
 Street NOYES No. 5-11
FOREST AVE Lot 102
 Block 1-10-5 Use of Bldg. Garage Name
 Tenants and Rooms 1-1 Room
 Rentals OWNER
 Age 20 YEARS
 Condition of Repair GOOD THROUGHOUT

<input type="checkbox"/> Bungalow	<input type="checkbox"/> Exterior Clapboards	<input type="checkbox"/> Plumbing Common
<input type="checkbox"/> Single House	<input type="checkbox"/> Siding	<input type="checkbox"/> Individual
<input type="checkbox"/> Two family	<input type="checkbox"/> Shingles	<input type="checkbox"/> Open
<input type="checkbox"/> Three family	<input type="checkbox"/> Stucco	<input type="checkbox"/> Set tubs
<input type="checkbox"/> Apartment	<input type="checkbox"/> Paper	<input type="checkbox"/> Finish
<input type="checkbox"/> Store Building	<input type="checkbox"/> Tapestry Brick	<input checked="" type="checkbox"/> Plain
<input type="checkbox"/> Office	<input type="checkbox"/> Com. Brick	<input type="checkbox"/> Hardwood
<input type="checkbox"/> Factory	<input type="checkbox"/> Galv. Iron	<input type="checkbox"/> Halls
<input type="checkbox"/> Storage	<input type="checkbox"/> Stone	<input type="checkbox"/> Wood
<input type="checkbox"/> Stables	<input type="checkbox"/> Terra Cotta	<input type="checkbox"/> Terrazzo
<input checked="" type="checkbox"/> Garage, private	<input type="checkbox"/> Concrete	<input type="checkbox"/> Marble
<input type="checkbox"/> Garage, public		
<input type="checkbox"/> Theatre	<input type="checkbox"/> Heating Stove	<input type="checkbox"/> Roof - Roofing
<input type="checkbox"/> Club House	<input type="checkbox"/> Furnace	<input type="checkbox"/> Shingle
<input type="checkbox"/> Cottage	<input type="checkbox"/> Hot Water	<input checked="" type="checkbox"/> Slate
	<input type="checkbox"/> Steam	<input type="checkbox"/> Gravel
<input type="checkbox"/> Foundation Brick	<input type="checkbox"/> Light	<input type="checkbox"/> Prepared
<input type="checkbox"/> Stone	<input type="checkbox"/> Oil	<input type="checkbox"/> Asbestos
<input type="checkbox"/> Concrete	<input type="checkbox"/> Gas	<input type="checkbox"/> Flat
<input type="checkbox"/> Pile	<input checked="" type="checkbox"/> Electric	<input type="checkbox"/> Hip
<input type="checkbox"/> Basement Full		<input checked="" type="checkbox"/> Gable
<input type="checkbox"/> Cement Floor	<input type="checkbox"/> Floor Common	<input type="checkbox"/> Dormers
<input type="checkbox"/> Waterproof	<input type="checkbox"/> Hardwood	<input checked="" type="checkbox"/> Windows Plain Glass
<input type="checkbox"/> Construction	<input type="checkbox"/> Re-Concrete	<input type="checkbox"/> Wire Glass
<input checked="" type="checkbox"/> Frame Brick	<input type="checkbox"/> Concrete Slab	<input type="checkbox"/> Shutters
<input type="checkbox"/> Tile	<input type="checkbox"/> Waterproof	<input type="checkbox"/> Miscellaneous
<input type="checkbox"/> Blocks	<input type="checkbox"/> Ceiling	<input type="checkbox"/> Elevator
<input type="checkbox"/> Stucco	<input type="checkbox"/> Plaster	<input type="checkbox"/> Sprinkler
<input type="checkbox"/> Re-Concrete	<input type="checkbox"/> Metal	<input type="checkbox"/> Fire Escape
<input type="checkbox"/> Mill	<input type="checkbox"/> Panelled	<input type="checkbox"/> Refrigerator
<input type="checkbox"/> Steel Frame	<input type="checkbox"/> Rough	<input type="checkbox"/> Vacuum Cleaner
		<input type="checkbox"/> Safes and Vaults
		<input type="checkbox"/> Telephone Equip.

Ground Area 1291 Height 25'
 Cubic Feet 32,275 Unit 10 Cts. 600
 Utility Dep.
 Dep. 80 Per cent.
Sound Value, \$ 6.46

Land 173.28 Area Questioned
 Corner Interior Alley
 Front Depth = ft.

COMPUTATION
~~10,000 x 100 x .50 = 5000~~
~~10,000 x .20 = 2000~~
~~4000 x 100 x .20 = 8000~~
~~3228 x 100 x .50 = 1614~~
 = 1397

Area	Multiplier	Coefficient	
	R		
Year	Unit	Coefficient	Land Value
19			# 7697-



Surveyed by [Signature]
 JUN 24 1924
 (Remarks on other Side)
 242

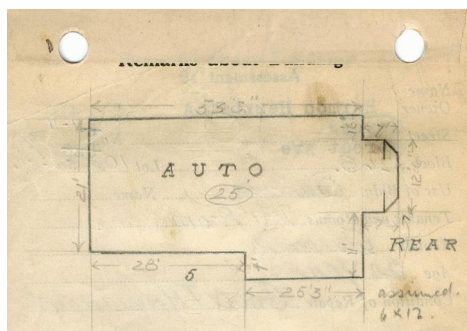

6x12 NOYES ST
 28x21 = 588 } x25 = 32,275
 25.25x25 = 631 }
 1291

Remarks about Land

Remarks about Personal Property

CITY OF PORTLAND, MAINE
 ASSESSORS DEPARTMENT

CHART	BLOCK
3	Building Volumes Checked
4	Building Values Placed
5	Building Values Extended
6	Land Only Questionnaire Made
7	Land Values Placed
8	Land Values Extended
9	Compare with 1923
10	Final Report Added

1924 Portland Tax Records: 1-11 Noyes Street, Portland, 1924

www.mainememory.net/item/66011
Collections of City of Portland - Planning & Development



Owner: Herbert A. Harmon
Address: 1-11 Noyes Street, Oakdale, Portland, Maine
Use: Garage
Local Code: Block 126B Lot 10 Book 54 Page 2
MMN item number: 66011