

1924 Portland Tax Records: 53-57 Park Street, Portland, 1924

L-3100
B-2500

Portland, Maine
Assessment 19

Name Talbot Elizabeth L Hrs 53-57
Owner Talbot Elizabeth L Hrs 53-57
Street Danforth No. 104-112
Block 44 Block A Lot 26
Use of Bldg. Dwelling Name
Tenants and Rooms 18 Pms 1 Family
Rentals 75.00
Age B.L.D.
Condition of Repair Good #57

Class	Exterior	Plumbing
Bungalow	Clapboards	Common
Single House	Siding	Individual
Two family	Shingles	Open
Three family	Stucco	Set tubs
Apartment	Paper	Finish
Store Building	Tapestry Brick	Plain
Office	Com. Brick	Hardwood
Factory	Galv. Iron	Halls
Stables	Stone	Wood
Garage, private	Terra Cotta	Terrazzo
Garage, public	Concrete	Marble
Theatre	Heating	Roof - Roofing
Club House	Stove	Shingle
Cottage	Furnace	Slate
	Hot Water	Gravel
Foundation	Steam	Prepared
Brick	Light	Asbestos
Stone	Oil	Flat
Concrete	Gas	Hip
Pile	Electric	Gable
Basement		Dormers
Full	Floor	Windows
Cement Floor	Common	Plain Glass
Waterproof	Hardwood	Wire Glass
	Re-Concrete	Shutters
Construction	Concrete Slab	Miscellaneous
Frame	Waterproof	Elevator
Brick		Sprinkler
Tile	Ceiling	Fire Escape
Blocks	Plaster	Refrigerator
Stucco	Metal	Vacuum Cleaner
Re-Concrete	Panelled	Safes and Vaults
Mill	Rough	Telephone Equip.
Steel Frame		

Ground Area 2252 sq ft Height 27'6"
Cubic Feet 61934 Unit 19 cts.
Utility Dep. 123
Dep. 70 Per cent.
- Sound Value, \$ 3344

Land 8806 Corner Interior Alley
Front 76' Depth 119'6" = ft.
ON PARK ST

COMPUTATION
2500 X 117 X 30 = 2632
7500 X 18 = 337
1308 X 117 X 30 = 458

Area	Multiplier	Coefficient
5806		
Year 1924	Coefficient	Land Value
19	Unit	\$3427



Surveyed by E.D.F. HALLEY-BROWN
(Remarks on other Side) 1/13/24

Remarks about Buildings

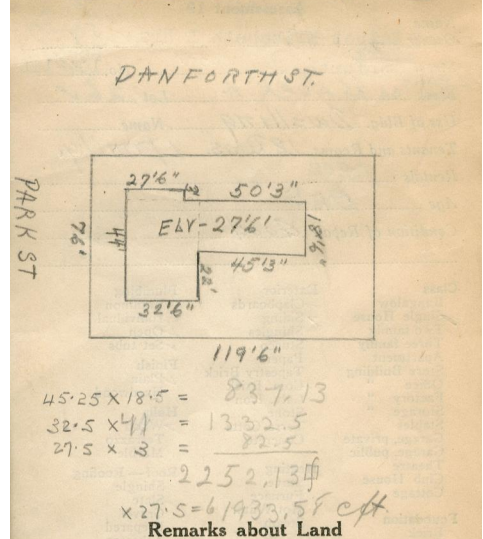

Remarks about Land

Remarks about Personal Property

CITY OF PORTLAND, MAINE
ASSESSORS DEPARTMENT

CHART	BLOCK
3	Building Volumes Checked 1182
4	Building Values Placed 102
5	Building Values Extended
6	Land Only Questionnaire Made
7	Land Values Placed
8	Land Values Extended
9	Compared with 1923
10	Force of Property Added

1924 Portland Tax Records: 53-57 Park Street, Portland, 1924

www.maine-memory.net/item/69136
Collections of City of Portland - Planning & Development



Owner: Heirs of Elizabeth L. Talbot
Address: 53-57 Park Street, West End, Portland, Maine
Use: Dwelling - Single family
Local Code: Block 44A Lot 26 Book 57 Page 1
MMN item number: 69136