

1924 Portland Tax Records: 131 Preble Street, Portland, 1924

Port land, 13 line
 Assessment 19
 Name Texas Co (Preble St Station)
 Street Preble (leased land) No. 131
 Block 24 Lot 1
 Use of Bldg. Warehouse Name
 Tenants and Rooms 1 - 2 Rms
 Rentals 2400.00
 Age 1895
 Condition of Repair EXTERIOR GOOD
INTERIOR GOOD

| | | |
|--|---|--|
| <input checked="" type="checkbox"/> Bungalow | <input checked="" type="checkbox"/> Exterior Clapboards | <input checked="" type="checkbox"/> Plumbing Common |
| <input checked="" type="checkbox"/> Single House | <input checked="" type="checkbox"/> Siding | <input checked="" type="checkbox"/> Individual |
| <input checked="" type="checkbox"/> Two family | <input checked="" type="checkbox"/> Shingles | <input checked="" type="checkbox"/> Open |
| <input checked="" type="checkbox"/> Three family | <input checked="" type="checkbox"/> Stucco | <input checked="" type="checkbox"/> Set tubs |
| <input checked="" type="checkbox"/> Apartment | <input checked="" type="checkbox"/> Paper | <input checked="" type="checkbox"/> Finish Plain |
| <input checked="" type="checkbox"/> Store Building | <input checked="" type="checkbox"/> Tapestry Brick | <input checked="" type="checkbox"/> Hardwood |
| <input checked="" type="checkbox"/> Office | <input checked="" type="checkbox"/> Com. Brick | <input checked="" type="checkbox"/> Halls |
| <input checked="" type="checkbox"/> Factory | <input checked="" type="checkbox"/> Galv. Iron | <input checked="" type="checkbox"/> Wood |
| <input checked="" type="checkbox"/> Storage | <input checked="" type="checkbox"/> Stone | <input checked="" type="checkbox"/> Terrazzo |
| <input checked="" type="checkbox"/> Stables | <input checked="" type="checkbox"/> Terra Cotta | <input checked="" type="checkbox"/> Marble |
| <input checked="" type="checkbox"/> Garage, private | <input checked="" type="checkbox"/> Concrete | <input checked="" type="checkbox"/> Roof - Roofing |
| <input checked="" type="checkbox"/> Garage, public | <input checked="" type="checkbox"/> Heating Stove | <input checked="" type="checkbox"/> Shingle |
| <input checked="" type="checkbox"/> Theatre | <input checked="" type="checkbox"/> Furnace | <input checked="" type="checkbox"/> Slate |
| <input checked="" type="checkbox"/> Club House | <input checked="" type="checkbox"/> Hot Water | <input checked="" type="checkbox"/> Gravel |
| <input checked="" type="checkbox"/> Cottage | <input checked="" type="checkbox"/> Steam | <input checked="" type="checkbox"/> Prepared |
| <input checked="" type="checkbox"/> Foundation Brick | <input checked="" type="checkbox"/> Light Oil | <input checked="" type="checkbox"/> Asbestos |
| <input checked="" type="checkbox"/> Stone | <input checked="" type="checkbox"/> Gas | <input checked="" type="checkbox"/> Flat |
| <input checked="" type="checkbox"/> Concrete | <input checked="" type="checkbox"/> Electric | <input checked="" type="checkbox"/> Hip |
| <input checked="" type="checkbox"/> Pile | <input checked="" type="checkbox"/> Floor Common | <input checked="" type="checkbox"/> Gable |
| <input checked="" type="checkbox"/> Basement Full | <input checked="" type="checkbox"/> Hardwood | <input checked="" type="checkbox"/> Dormers |
| <input checked="" type="checkbox"/> Cement Floor | <input checked="" type="checkbox"/> Re-Concrete | <input checked="" type="checkbox"/> Windows Plain Glass |
| <input checked="" type="checkbox"/> Waterproof | <input checked="" type="checkbox"/> Concrete Slab | <input checked="" type="checkbox"/> Wire Glass |
| <input checked="" type="checkbox"/> Construction Frame | <input checked="" type="checkbox"/> Waterproof | <input checked="" type="checkbox"/> Shutters |
| <input checked="" type="checkbox"/> Brick | <input checked="" type="checkbox"/> Ceiling Plaster | <input checked="" type="checkbox"/> Miscellaneous Elevator |
| <input checked="" type="checkbox"/> Tile | <input checked="" type="checkbox"/> Metal | <input checked="" type="checkbox"/> Sprinkler |
| <input checked="" type="checkbox"/> Blocks | <input checked="" type="checkbox"/> Panelled | <input checked="" type="checkbox"/> Fire Escape |
| <input checked="" type="checkbox"/> Stucco | <input checked="" type="checkbox"/> Rough | <input checked="" type="checkbox"/> Refrigerator |
| <input checked="" type="checkbox"/> Re-Concrete | | <input checked="" type="checkbox"/> Vacuum Cleaner |
| <input checked="" type="checkbox"/> Mill | | <input checked="" type="checkbox"/> Safes and Vaults |
| <input checked="" type="checkbox"/> Steel Frame | | <input checked="" type="checkbox"/> Telephone Equip. |

Ground Area 163 Height 10'
 Cubic Feet 1630 Unit 10 cts.
 Utility Dep. 163 (75)
 Deb. 10.10 Per cent.

demolished - Oct 1925 - about 1924



Preble



Burned down, July 1929

Shot 16 Shot 17

Surveyed by W. H. ...

(Remarks on other Side) 13-24

Remarks about Buildings

Sheet 14

Sheet 13

Remarks about Land

PREBLE ST.

10 X 16.25 X 10 =

Remarks about Personal Property

| | |
|-------------------------|------------------------------|
| CITY OF PORTLAND, MAINE | |
| ASSESSORS DEPARTMENT | |
| CHART | BLOCK <u>7</u> |
| 3 | Building Volumes Checked |
| 4 | Building Values Placed |
| 5 | Building Values Extended |
| 6 | Land Only Questionnaire Made |
| 7 | Land Values Placed |
| 8 | Land Values Extended |
| 9 | Compared With 1923 |
| 10 | Personal Property Added |

34,050

34,450 Gallons

16.25

10'

16.25 X 10 = 163 X 10 = 1630

Sheet 14

Sheet 13

Sheet 14

Sheet 13

10 X 16.25 X 10 =

13-24

1924 Portland Tax Records: 131 Preble Street, Portland, 1924

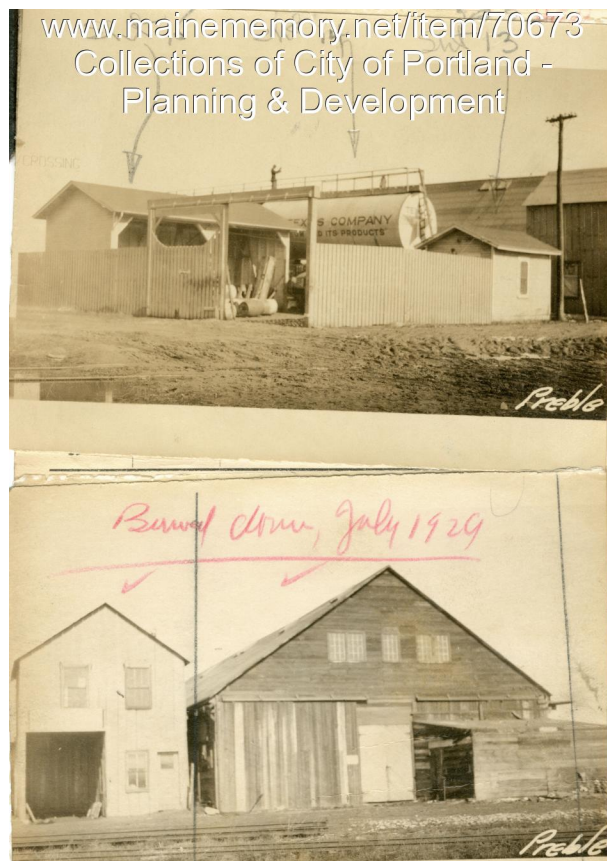

Owner: Texas Company (Preble Street Station)
Address: 131 Preble Street, Bayside, Portland, Maine
Use: Pump House
Local Code: Block 34D Lot 1 Book 62 Page 13
MMN item number: 70673