

1924 Portland Tax Records: 100 Revere Street, Portland, 1924

L 900  
B 4000 #10/2

Portland, Maine

Assessment 19

Name Cheney Chase E & Stella A

Owner Cheney Chase E & Stella A

Street Revere No. 100

Block 1240 Lot 11

Use of Bldg. Dwelling Name.....

Tenants and Rooms 2 rms + bath

Rentals 20 month up - Owns & lives here

Age 20 yrs

Condition of Repair Good inside except cracked Ceilings - Good outside except paint

<b>Class</b>	<b>Exterior</b>	<b>Plumbing</b>
Bungalow	-Clapboards	Common
Single House	Siding	Individual
-Two family	Shingles	-Open
Three family	Stucco	-Set tubs
Apartment	Paper	<b>Finish</b>
Store Building	Papestry Brick	-Plain
Office "	Com. Brick	Hardwood
Factory "	Galv. Iron	<b>Halls</b>
Storage "	Stone	-Wood
Stables	Terra Cotta	Terrazzo
Garage, private	Concrete	Marble
Garage, public	<b>Heating</b>	<b>Roof - Roofing</b>
Theatre	Stove	-Shingle
Club House	Furnace	Slate
Cottage	Hot Water	Gravel
	-Steam	Prepared
<b>Foundation</b>	<b>Light</b>	Asbestos
-Brick	Oil	Flat
-Stone	Gas	Hip
Concrete	-Electric	-Gable
Pile		Dormers
<b>Basement</b>	<b>Floor</b>	<b>Windows</b>
-Full	Common	-Plain Glass
Cement Floor	-Hardwood	Wire Glass
Waterproof	Re-Concrete	Shutters
<b>Construction</b>	Concrete Slab	<b>Miscellaneous</b>
-Frame	Waterproof	Elevator
Brick	<b>Ceiling</b>	Sprinkler
Tile	-Plaster	Fire Escape
Blocks	Metal	Refrigerator
Stucco	Panelled	Vacuum Cleaner
Re-Concrete	Rough	Safes and Vaults
Mill		Telephone Equip.
Steel Frame		

Ground Area 1254 Height 30'

Cubic Feet 41382 Unit 15 cts.

Utility Dep. ....

Dep. 30 Per cent.

Sound Value, \$ 4345

Land 5000 Corner..... Interior..... Alley

Front ..... Depth ..... = ..... ft.

COMPUTATION

Area	Multiplier	Coefficient	
5000	100	5000	
Year	Unit	Coefficient	Land Value
19	.16	5000	(#800) - X



Surveyed by A. J. Sears

MAY 3 1 1924

(Remarks on other Side) 1142

125 - 1173/263 - 13500.4

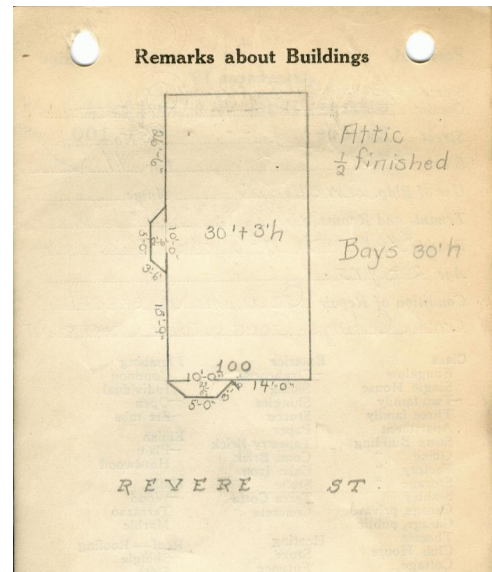

Remarks about Land

1254

$24 \times 52.25 \times 33 = 41382$

$2(75 \times 25) \times 30 =$

Remarks about Personal Property

CITY OF PORTLAND, MAINE

ASSESSORS DEPARTMENT

CHART	BLOCK
3 Building Volumes Checked	<u>800</u>
4 Building Values Placed	<u>1142</u>
5 Building Values Extended	
6 Land Only Questionnaire Made	
7 Land Values Placed	
8 Land Values Extended	
9 Compared With 1923	
10 Personal Property Added	

1924 Portland Tax Records: 100 Revere Street, Portland, 1924

[www.maine-memory.net/item/72674](http://www.maine-memory.net/item/72674)  
Collections of City of Portland - Planning & Development



**Owner:** Chase E. Cheney  
**Address:** 100 Revere Street, Woodfords, Portland, Maine  
**Use:** Dwelling - Two family  
**Local Code:** Block 124C Lot 11 Book 64 Page 1  
**MMN item number:** 72674  
**Notes:** The property was also owned by Stella A. Cheney. The property was subsequently owned by Everett Building Company.