

1924 Portland Tax Records: 101 Riverside Street (rear), Portland, 1924

Exempt L 400+ B 200+ 10/3

Portland, Maine
 Assessment 19
 Name *CAMPBELL ANNIE WIDOW CWV*
 Street *RIVERSIDE* No. *71*
 Block *316A* Lot *4 R-203*
 Use of Bldg. *DWELLING* Name.....
 Tenants and Rooms. *1-6*
 Rentals *OWNER OCCUPIES*
 Age *60 YEARS*
 Condition of Repair *F.A.R.*

Class	Exterior	Plumbing
<input checked="" type="checkbox"/> Bungalow	<input checked="" type="checkbox"/> Clapboards	<input checked="" type="checkbox"/> Common
<input checked="" type="checkbox"/> Single House	<input checked="" type="checkbox"/> Siding	<input type="checkbox"/> Individual
<input type="checkbox"/> Two family	<input type="checkbox"/> Shingles	<input type="checkbox"/> Open
<input type="checkbox"/> Three family	<input type="checkbox"/> Stucco	<input type="checkbox"/> Set tubs
<input type="checkbox"/> Apartment	<input type="checkbox"/> Paper	Finish
<input type="checkbox"/> Store Building	<input type="checkbox"/> Tapestry Brick	<input checked="" type="checkbox"/> Plain
<input type="checkbox"/> Office "	<input type="checkbox"/> Com. Brick	<input type="checkbox"/> Hardwood
<input type="checkbox"/> Factory "	<input type="checkbox"/> Galv. Iron	Halls
<input type="checkbox"/> Storage "	<input type="checkbox"/> Stone	<input checked="" type="checkbox"/> Wood
<input type="checkbox"/> Stables	<input type="checkbox"/> Terra Cotta	<input type="checkbox"/> Terrazzo
<input type="checkbox"/> Garage, private	<input type="checkbox"/> Concrete	<input type="checkbox"/> Marble
<input type="checkbox"/> Garage, public	Heating	Roof - Roofing
<input type="checkbox"/> Theatre	<input checked="" type="checkbox"/> Stove	<input checked="" type="checkbox"/> Shingle
<input type="checkbox"/> Cottage	<input type="checkbox"/> Furnace	<input type="checkbox"/> Slate
	<input type="checkbox"/> Hot Water	<input type="checkbox"/> Gravel
	<input type="checkbox"/> Steam	<input type="checkbox"/> Prepared
Foundation	<input type="checkbox"/> Light	<input type="checkbox"/> Asbestos
<input checked="" type="checkbox"/> Brick FRONT	<input checked="" type="checkbox"/> Oil	<input type="checkbox"/> Flat
<input type="checkbox"/> Concrete	<input type="checkbox"/> Gas	<input type="checkbox"/> Hip
<input type="checkbox"/> Pile	<input type="checkbox"/> Electric	<input checked="" type="checkbox"/> Gable
<input checked="" type="checkbox"/> Posts REAR		<input type="checkbox"/> Dormers
Basement		Windows
<input checked="" type="checkbox"/> Full FRONT		<input checked="" type="checkbox"/> Plain Glass
<input checked="" type="checkbox"/> Cement Floor	Floor	<input type="checkbox"/> Wire Glass
<input type="checkbox"/> Waterproof	<input checked="" type="checkbox"/> Common	<input type="checkbox"/> Shutters
<input checked="" type="checkbox"/> NO BASEMENT IN REAR	<input type="checkbox"/> Hardwood	Miscellaneous
<input checked="" type="checkbox"/> Construction REAR	<input type="checkbox"/> Re-Concrete	<input type="checkbox"/> Elevator
<input type="checkbox"/> Frame	<input type="checkbox"/> Concrete Slab	<input type="checkbox"/> Sprinkler
<input type="checkbox"/> Brick	<input type="checkbox"/> Waterproof	<input type="checkbox"/> Fire Escape
<input type="checkbox"/> Tile	Ceiling	<input type="checkbox"/> Refrigerator
<input type="checkbox"/> Blocks	<input checked="" type="checkbox"/> Plaster	<input type="checkbox"/> Vacuum Cleaner
<input type="checkbox"/> Stucco	<input type="checkbox"/> Metal	<input type="checkbox"/> Safes and Vaults
<input type="checkbox"/> Re-Concrete	<input type="checkbox"/> Panelled	<input type="checkbox"/> Telephone Equip.
<input type="checkbox"/> Mill	<input type="checkbox"/> Rough	
<input type="checkbox"/> Steel Frame		

Ground Area *813* Height *15'-22"*
 Cubic Feet. *16,447* Unit. *20* cts.
 Utility Dep.
 Dep. *75* Per cent.
 Sound Value, \$ *1091 with #2*

Land *120* Corner..... Interior..... Alley
 Front..... Depth..... =..... ft.
 COMPUTATION

Area	Multiplier	Coefficient

Year	Unit	Coefficient	Land Value
19			

Sketch 1 2 3

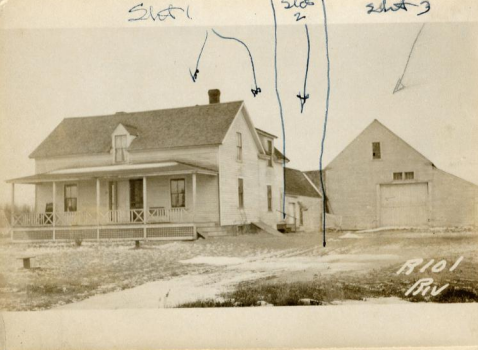

Surveyed by *C.F. Higgins*
 (Remarks on other Side) *10/3*

Remarks about Buildings
1 1/2 Story frame house
 $15.33 \times 13.33 = \dots \times 15'0"$
 $33.33 \times 18.25 = \dots \times 22'0"$

204.35	3,065.25
608.27	13,381.94
<u>812.62</u>	<u>16,447.</u>

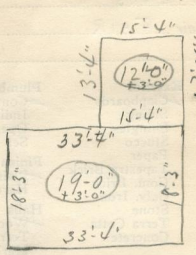

Riverside St.
Remarks about Land

Remarks about Personal Property

CITY OF PORTLAND
 ASSESSORS DEPARTMENT
 CHART..... BLOCK.....

3	Building Volume Checked	<i>CR</i>
4	Building Values Placed	
5	Building Values Extended	<i>1092</i>
6	Land Only Questionnaire Made	
7	Land Values Placed	
8	Land Values Extended	
9	Comparative 1913	
10	Values in This Report Added	

1924 Portland Tax Records: 101 Riverside Street (rear), Portland, 1924

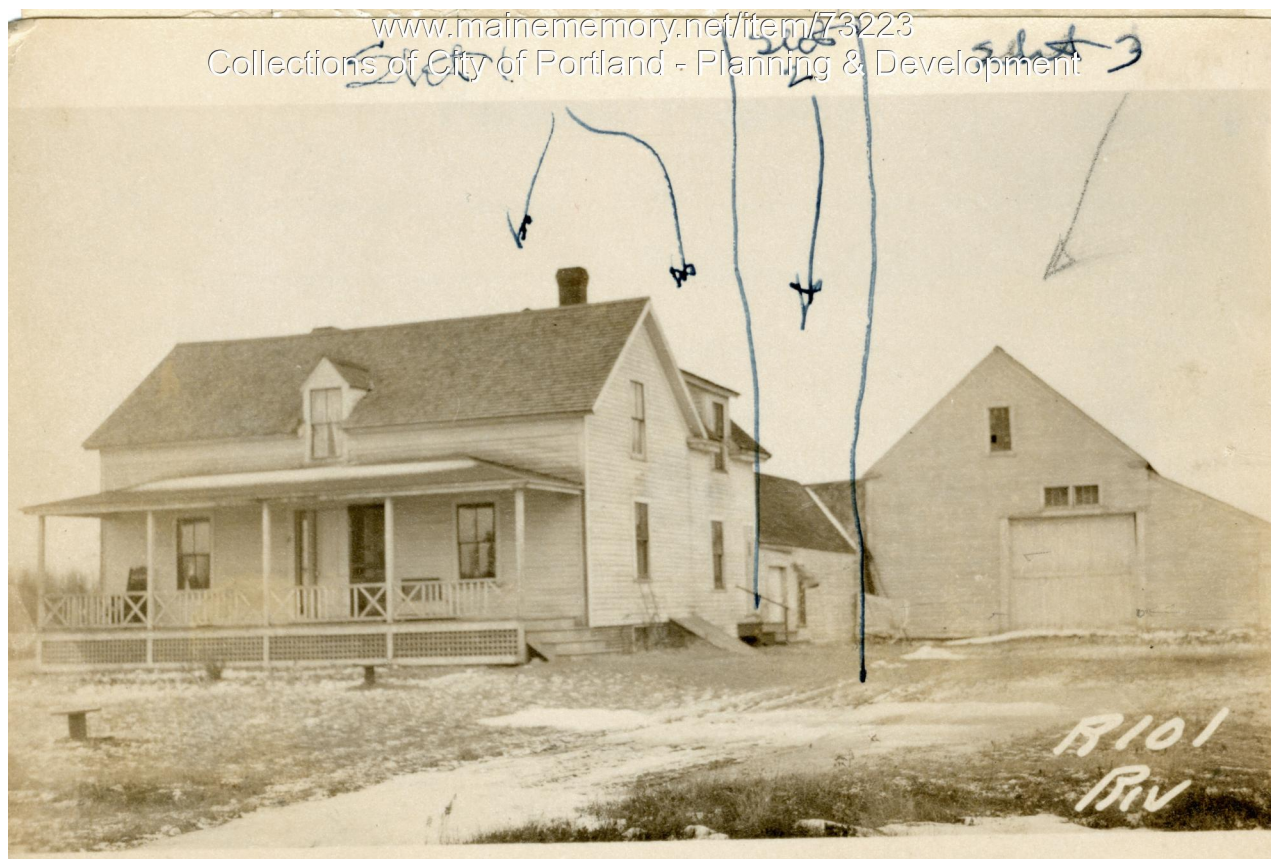

Owner: Annie Campbell
Address: 101 Riverside Street (rear), Riverside, Portland, Maine
Use: Dwelling - Single family
Local Code: Block 316A Lot 4 Book 64 Page 1
MMN item number: 73223
Notes: The property is listed on therecord as a Widow of a Civil War Veteran.