

1924 Portland Tax Records: 253 Spring Street, Portland, 1924

Owner Morr. Jennie L.
 Street Spring No. 253-255
 Block 56 Lot 34
 Use of Bldg. Dwelling Name.....
 Tenants and Rooms Owner - 7 1/2, Rented
 Rentals.....
 Age 30 years
 Condition of Repair Good # 255

| | | |
|---------------------|-------------------|--------------------------|
| Class | Exterior | Plumbing |
| Bungalow | Clapboards | Common |
| Single House | Siding | Individual |
| Two family | Shingles | Open |
| Three family | Stucco | Set tubs |
| Apartment | Paper | Finish |
| Store Building | Tapestry Brick | Plain |
| Office " | Com. Brick | Hardwood |
| Factory " | Galv. Iron | Halls |
| Storage " | Stone | Wood |
| Stables | Terra Cotta | Terrazzo |
| Garage, private | Concrete | Marble |
| Garage, public | | Roof - Roofing |
| Theatre | | Shingle |
| Club House | Heating | Slate |
| Cottage | Stove | Gravel |
| | Furnace | Prepared <i>Shingles</i> |
| | Hot Water | Asbestos |
| | Steam | Flat |
| Foundation | Light | Hip |
| Brick | Oil | Cable |
| Stone | Gas | Dormers |
| Concrete | Electric | Windows |
| Pile | | Plain Glass |
| Basement | Floor | Wire Glass |
| Full | Common | Shutters |
| Cement Floor | Hardwood <u>6</u> | Miscellaneous |
| Waterproof | Re-Concrete | Elevator |
| Construction | Concrete Slab | Sprinkler |
| Frame | Waterproof | Fire Escape |
| Brick | Ceiling | Refrigerator |
| Tile | Plaster | Vacuum Cleaner |
| Block | Metal | Safes and Vaults |
| Stone | Panelled | Telephone Equip. |
| Re-Concrete | Rough | |
| Mill | | |
| Steel Frame | | |

Ground Area 1293 # Height 33-25-20
 Cubic Feet 40,680 # Unit 16 cts.
 Utility Dep. 3150
 Dep. 50 Per cent. 31
Sound Value, \$ 3254 3300

Land 2337 Corner..... Interior..... Alley
 Front..... Depth..... =..... ft.
 COMPUTATION

R=600

| Area | Multiplier | Coefficient | |
|------|------------|-------------|------------|
| 2337 | 102 | 2343 | |
| Year | Unit | Coefficient | Land Value |
| 19 | 330 | 2383 | 714 |

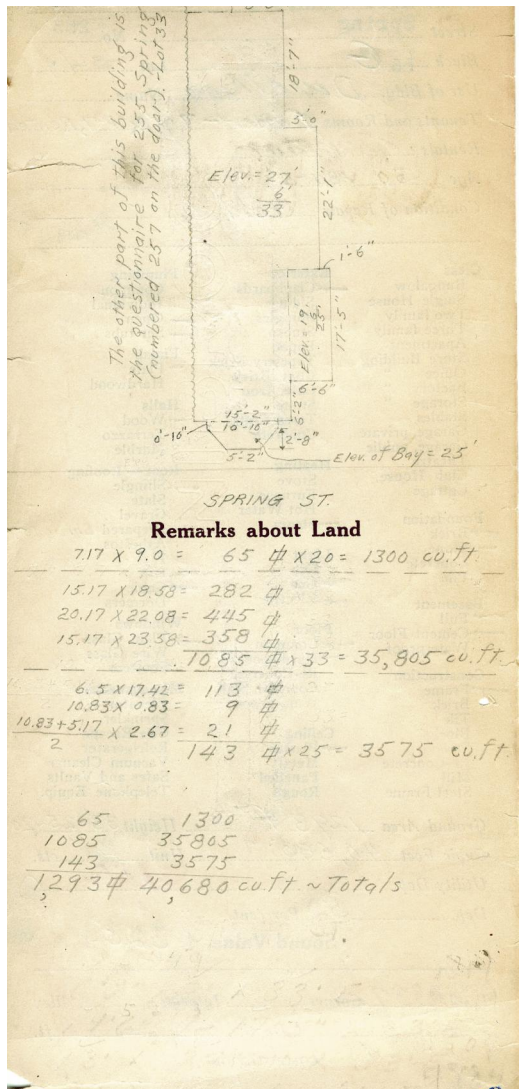

Remarks about Personal Property A. C. MacCabe

CITY OF PORTLAND, MAINE
 ASSESSORS DEPARTMENT

| CHART | BLOCK |
|--------------------------------|------------|
| 3 Building Volumes Checked | <u>116</u> |
| 4 Building Values Placed | <u>116</u> |
| 5 Building Values Extended | <u>116</u> |
| 6 Land City Questionnaire Made | <u>116</u> |
| 7 Land Values Placed | <u>116</u> |
| 8 Land Values Extended | <u>116</u> |
| 9 compared with 1923 | <u>116</u> |
| 10 Total Property Added | <u>116</u> |

1924 Portland Tax Records: 253 Spring Street, Portland, 1924



Owner: Jennie L. Horr
Address: 253 Spring Street, West End, Portland, Maine
Use: Dwelling - Two family
Local Code: Block 56G Lot 34 Book 68 Page 1
MMN item number: 76403