

1924 Portland Tax Records: 363 St. John Street, Portland, 1924

Portland, Maine # 12
 Assessment 19
 Name Libby Fredrick H
 Owner Libby Fredrick H
 Street Washington Ave No. 124-136
 Block 4H Lot 9
 Use of Bldg. stable + Garage Name.....
 Tenants and Rooms.....
 Rentals.....
 Age 20+
 Condition of Repair Fair

- | | | |
|---------------------|-----------------|-----------------------|
| Class | Exterior | Plumbing |
| Bungalow | Clapboards | Common |
| Single House | Siding | Individual |
| Two family | Shingles | Open |
| Three family | Stucco | Set tubs |
| Apartment | Paper | |
| Store Building | Tapestry Brick | Finish |
| Office | Com. Brick | Plain |
| Factory | Galv. Iron | Hardwood |
| Storage | Stone | |
| Stables | Terra Cotta | Halls |
| Garage, private | Concrete | Wood |
| Garage, public | | Terrazzo |
| Theatre | | Marble |
| Club House | Heating | |
| Cottage | Stove | Roof - Roofing |
| | Furnace | Shingle |
| | Hot Water | Slate |
| | Steam | Gravel |
| Foundation | | Prepared |
| Brick | | Asbestos |
| Stone | Light | Flat |
| Concrete | Oil | Hip |
| Pile | Gas | Gable |
| | Electric | Dormers |
| Basement | | Windows |
| Full | | Plain Glass |
| Cement Floor | Floor | Wire Glass |
| Waterproof | Common | Shutters |
| | Hardwood | |
| Construction | Re-Concrete | Miscellaneous |
| Frame | Concrete Slab | Elevator |
| Brick | Waterproof | Sprinkler |
| Tile | | Fire Escape |
| Blocks | Ceiling | Refrigerator |
| Stucco | Plaster | Vacuum Cleaner |
| Re-Concrete | Metal | Safes and Vaults |
| Mill | Panelled | Telephone Equip. |
| Steel Frame | Rough | |

Ground Area 1351.14 Height 15-20-2
 Cubic Feet 22282.91 Unit 60
 Utility Dep.
 Dep. 55 Per cent.
 Sound Value, \$ 602

Land..... Corner..... Interior..... Alley
 Front..... Depth..... =..... ft.
 COMPUTATION

| Area | Multiplier | Coefficient | |
|------|------------|-------------|------------|
| | | | |
| Year | Unit | Coefficient | Land Value |
| 19 | | | |



Surveyed by W. H. Arnold
 (Remarks on other Side) 3-2
 APR - 5 1924

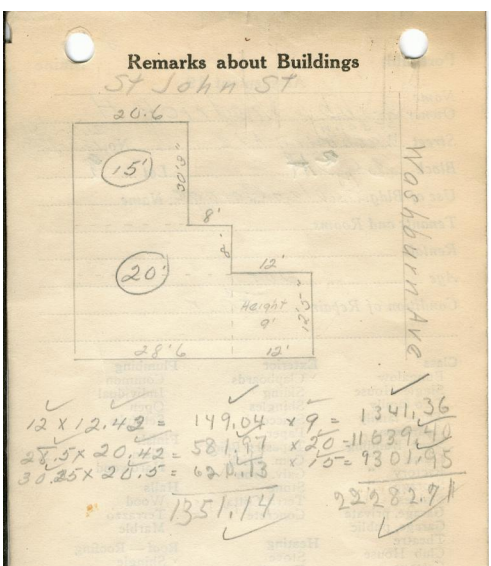

Remarks about Land

| | |
|-----------------|----------------|
| 1242 | 26.42 |
| 12 | 20.42 |
| 2484 | 5284 |
| 1242 | 10568 |
| 149.04 sq ft | 5184 |
| 9 | 53949.64 |
| 1341.36 cu ft | 539.50 sq ft |
| 30.25 | 20 |
| 20.42 | 10798.00 cu ft |
| 6050 | |
| 12100 | |
| 6050 | |
| 617,705.0 sq ft | |
| 617.71 sq ft | |
| 308855 | |
| 61771 | |
| 9365.65 cu ft | |

Remarks about Personal Property

CITY OF PORTLAND, MAINE
 ASSESSORS DEPARTMENT

| CHART | BLOCK |
|-------|--|
| 3 | Building Volumes Checked <u>initials</u> |
| 4 | Building Values Placed <u>initials</u> |
| 5 | Building Values Extended <u>initials</u> |
| 6 | Land Only Questionnaire Made |
| 7 | Land Values Placed |
| 8 | Land Values Extended |
| 9 | Compared With 1923 |
| 10 | Personal Property Added |

1924 Portland Tax Records: 363 St. John Street, Portland, 1924



Owner: Frederick H. Libby
Address: 363 St. John Street, Parkside, Portland, Maine
Use: Stable (as Garage)
Local Code: Block 66H Lot 9 Book 71 Page 2
MMN item number: 76834