

1924 Portland Tax Records: 18-20 St. Lawrence Street, Portland, 1924

NON-RESIDENT ^{L 800 #163}
 Portland, Maine
 Assessment 19 **1-3**
 Name *Briggs*
 Owner *Hight George G.*
 Street *St. Lawrence* No. *18-20*
 Block *16* Lot *7*
 Use of Bldg. *D* Name _____
 Tenants and Rooms *3* *3-5-6*
 Rentals *20-30 78 = 68 total monthly*
 Age *0.1 D*
 Condition of Repair *7.6.19*

- | | | |
|---------------------|---------------------|-----------------------|
| Class | Exterior | Plumbing |
| Bungalow | ✓ Clapboards | ✓ Common |
| Single House | Siding | Individual |
| Two family | Shingles | Open <i>CLOSED</i> |
| ✓ Three family | Stucco | Set tubs |
| Apartment | Paper | |
| Store Building | Tapestry Brick | Finish |
| Office " | Com. Brick | ✓ Plain |
| Factory " | Galv. Iron | Hardwood |
| Storage " | Stone | |
| Stables | Terra Cotta | Halls |
| Garage, private | Concrete | ✓ Wood |
| Garage, public | | Terrazzo |
| Theatre | | Marble |
| Club House | Heating | Roof - Roofing |
| Cottage | ✓ Stove | ✓ Single |
| | Furnace | Slate |
| | Hot Water | Gravel |
| | Steam | Prepared |
| Foundation | | Asbestos |
| ✓ Brick | Light | Flat |
| Stone | Oil | Hip |
| Concrete | ✓ Gas | Gable |
| Pile | Electric | Dormers |
| Basement | | Windows |
| ✓ Full | Floor | ✓ Plain Glass |
| ✓ Cement Floor | ✓ Common <i>3/4</i> | Wire Glass |
| Waterproof | ✓ Hardwood | Shutters |
| Construction | Re-Concrete | Miscellaneous |
| ✓ Frame | Concrete Slab | Elevator |
| Brick | Waterproof | Sprinkler |
| Tile | | Fire Escape |
| Block's | Ceiling | Refrigerator |
| Stucco | ✓ Plaster | Vacuum Cleaner |
| Re-Concrete | Metal | Safts and Vaults |
| Mill | Panelled | Telephone Equip. |
| Steel Frame | Rough | |

Ground Area *492* Height *24*
 Cubic Feet *10,488* Unit *18* cts.
 Utility Dep. _____
 Dep. *35* Per cent.
 - Sound Value, \$ *3288 with 13*

Land *4060* Corner _____ Interior _____ Alley _____
 Front _____ Depth _____ ft.

COMPUTATION

Area	Multiplier	Coefficient	
<i>4060</i>	<i>106</i>	<i>4303</i>	
Year	Unit	Coefficient	Land Value
<i>19</i>	<i>15</i>	<i>4303</i>	<i>645</i>



Surveyed by *C. A. [Signature]*
 (Remarks on other Side) *1-3*
23 115-203 4500-5000
25 117-333 St. 7000 (over)

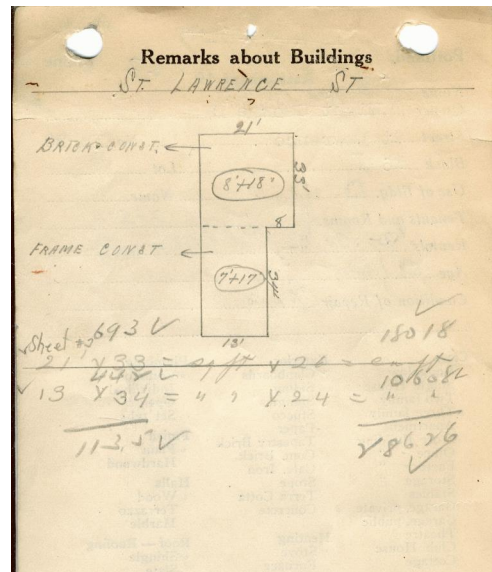

Remarks about Land

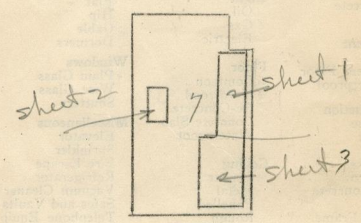

Remarks about Personal Property

CITY OF PORTLAND, ME
 ASSESSORS DEPARTMENT

CHART	BLOCK
3	Building Volumes Checked <i>B RMB</i>
4	Building Values Placed <i>ump</i>
5	Building Values Extended
6	Land Only Questionnaire Made
7	Land Values Placed
8	Land Values Extended
9	Compared With 1923
10	Personal Property Added
+0008 - 20/16M 21	

1924 Portland Tax Records: 18-20 St. Lawrence Street, Portland, 1924

www.maine-memory.net/item/76891
Collections of City of Portland - Planning & Development



Owner: George C. Hight
Address: 18-20 St. Lawrence Street, East End, Portland, Maine
Use: Dwelling - Three Family
Local Code: Block 16J Lot 7 Book 72 Page 1
MMN item number: 76891
Notes: The property was subsequently owned by K. G. Briggs.