

1924 Portland Tax Records: Rooming House, Tolman Place, Portland, 1924

4000  
4500  
13500

1-2

Portland, Maine

Assessment 19

Name \_\_\_\_\_  
 Owner Congress Realty Co  
 Street Tolman Place No. \_\_\_\_\_  
 Block 37 Block C Lot 13V  
 Use of Bldg. Rooming Name \_\_\_\_\_  
 Tenants and Rooms 40  
 Rentals \_\_\_\_\_  
 Age 30 years  
 Condition of Repair Good

<b>Class</b>	<b>Exterior</b>	<b>Plumbing</b>
Bungalow	Clapboards	- Common
Single House	Siding	Individual
Two family	Shingles	Open
Three family	Stucco	Set tubs
Apartment	Paper	<b>Finish</b>
Store Building	Tapestry Brick	- Plain
Office "	- Com. Brick	Hardwood
Factory "	Galv. Iron	<b>Halls</b>
Storage	Stone	- Wood
Stables	Terra Cotta	Terrazzo
Garage, private	Concrete	Marble
Garage, public		<b>Roof - Roofing</b>
Theatre	<b>Heating</b>	Shingle
Club House	Stove	Slate
Cottage	Furnace	- Gravel
	Hot Water	Prepared
<b>Foundation</b>	- Steam	Asbestos
- Brick	<b>Light</b>	- Flat
Stone	Oil	Hip
Concrete	Gas	Gable
Pile	- Electric	Dormers
<b>Basement</b>		<b>Windows</b>
Full	<b>Floor</b>	- Plain Glass
- Cement Floor	Common	Wire Glass
Waterproof	Hardwood	Shutters
<b>Construction</b>	Re-Concrete	<b>Miscellaneous</b>
Frame	Concrete Slab	Elevator
- Brick	Waterproof	Sprinkler
Tile	<b>Ceiling</b>	Fire Escape
Blocks	- Plaster	Refrigerator
Stucco	Metal	Vacuum Cleaner
Re-Concrete	Panelled	Safes and Vaults
Mill	Rough	Telephone Equip.
Steel Frame		

Ground Area 4410V Height 20.50  
 Cubic Feet 162,420V Unit 18 cts  
 Utility Dep. \_\_\_\_\_  
 Dep. 60 Per cent.  
 Sound Value, \$ 11694

Land 5959 Corner \_\_\_\_\_ Interior \_\_\_\_\_ Alley 116  
 Front \_\_\_\_\_ Depth \_\_\_\_\_ = \_\_\_\_\_ ft.

COMPUTATION

Area	Multiplier	Coefficient	
5959	121	7210	
Year	Unit	Coefficient	Land Value
19	<del>100</del>	7210	<del>45407</del> 7210



Surveyed by B. F. Cobb  
 (Remarks on other Side)

Remarks about Buildings

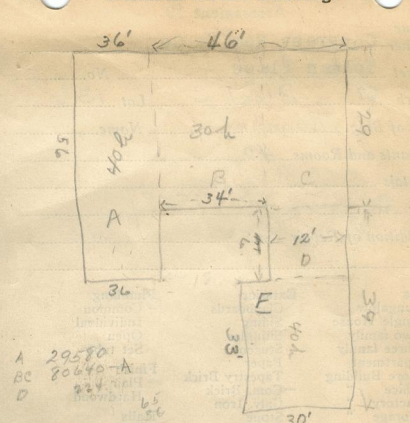

Remarks about Land

86 x 56 x 40 - 2016 - 80640  
 46 x 29 x 30 - 1334 - 90,020  
 12 x 6 x 30 - 72 - 2,160  
 33 x 30 x 40 - 990 - 39,600  
 9912 162420

Remarks about Personal Property

CITY OF PORTLAND, MAINE  
 ASSESSORS DEPARTMENT

CHART	BLOCK
3 Building Volumes Checked	214
4 Building Values Placed	
5 Building Values Extended	
6 Land Only Questionnaire Made	
7 Land Values Placed	
8 Land Values Extended	
9 Compared With 1923	
10 Personal Property Added	

1924 Portland Tax Records: Rooming House, Tolman Place, Portland, 1924

[www.mainememory.net/item/77886](http://www.mainememory.net/item/77886)  
Collections of City of Portland - Planning & Development

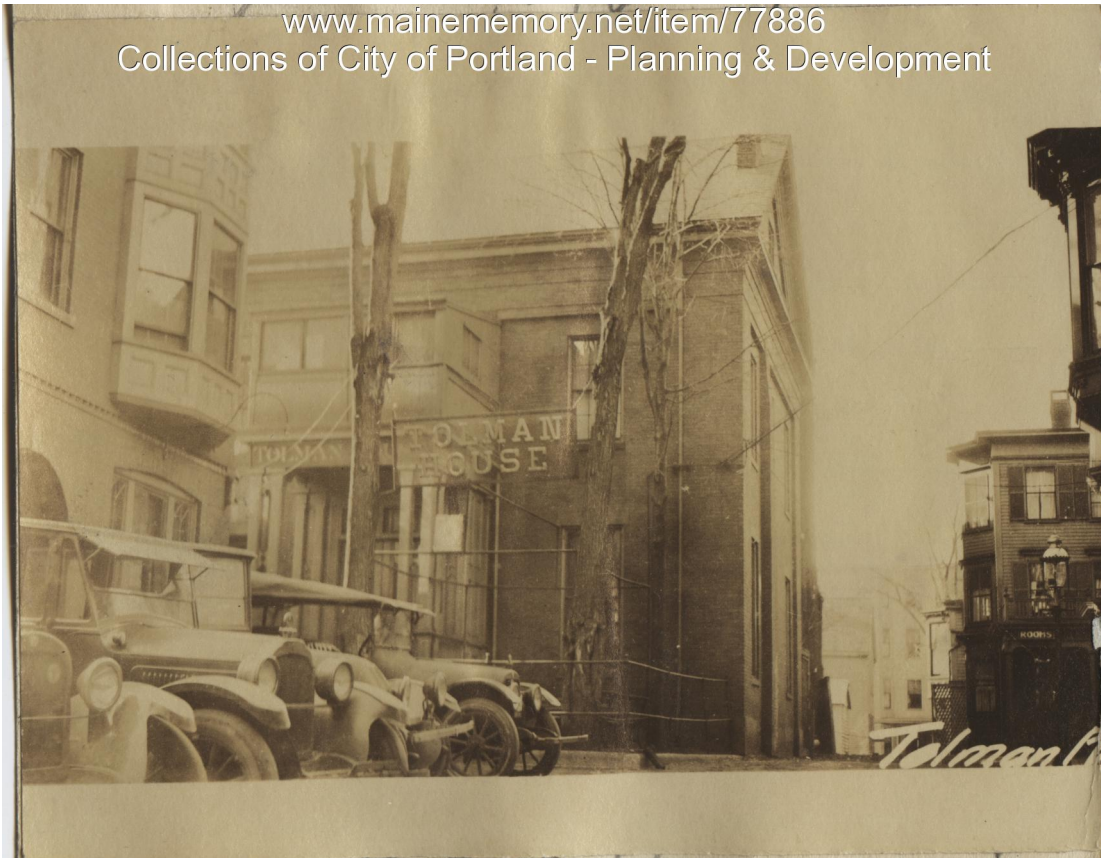

**Owner:** Congress Realty Company  
**Address:** Tolman Place, West End, Portland, Maine  
**Use:** Rooming House  
**Local Code:** Block 37C Lot 13 Book 74 Page 1  
**MMN item number:** 77886