

1924 Portland Tax Records: 526 Washington Avenue, Portland, 1924

Portland, Maine
 Assessment 19
 Name *Schreiber Morris R.*
 Owner *Leighton Julia E. T.*
 Street *Washington Ave* Sub. No. *526*
 Block *439D* Lot *2*
 Use of Bldg. *Residence* Name
 Tenants and Rooms *6 Rooms + Bath*
 Rentals *Quinn Macgregor*
 Age *30 years*
 Condition of Repair *Good*

- | | | |
|---------------------|-----------------|-----------------------|
| Class | Exterior | Plumbing |
| Bungalow | Clapboards | Common |
| Single House | Siding | Individual |
| Two family | Shingles | Open |
| Three family | Stucco | Set tubs |
| Apartment | Paper | Finish |
| Store Building | Tapestry Brick | Plain |
| Office | Com. Brick | Hardwood |
| Factory | Galv. Iron | |
| Storage | Stone | Halls |
| Stables | Terra Cotta | Wood |
| Garage, private | Concrete | Terrazzo |
| Garage, public | | Marble |
| Theatre | Heating | Roof - Roofing |
| Club House | Stove | Shingle |
| Cottage | Furnace | Slate |
| | Hot Water | Gravel |
| | Steam | Prepared |
| Foundation | | Asbestos |
| Brick | Light | Flat |
| Stone | Oil | Hip |
| Concrete | Gas | Cable |
| Pile | Electric | Dormers |
| Basement | | Windows |
| Full | Floor | Plain Glass |
| Cement Floor | Common | Wire Glass |
| Waterproof | Hardwood | Shutters |
| Construction | Re-Concrete | Miscellaneous |
| Frame | Concrete Slab | Elevator |
| Brick | Waterproof | Sprinkler |
| Tile | Ceiling | Fire Escape |
| Blocks | Plaster | Refrigerator |
| Stucco | Metal | Vacuum Cleaner |
| Re-Concrete | Panelled | Safes and Vaults |
| Mill | Rough | Telephone Equip. |
| Steel Frame | | |

Ground Area *936* Height *17'-29'-15"*
 Cubic Feet *22432* Unit *18* cts.
 Utility Dep. *40* Per cent.
 Dep. *40* Per cent.
 Sound Value, \$ *2423*

Land *7500* Corner Interior Alley
 Front Depth = ft.
 COMPUTATION

Area	Multiplier	Coefficient	
<i>7500</i>	<i>80</i>	<i>6000</i>	
Year	Unit	Coefficient	Land Value
<i>19</i>	<i>10</i>	<i>6000</i>	<i>\$6000</i>



Surveyed by *J.P.B.*
 APR 1 1924
 (Remarks on other Side)
24 - 7443/156 - 3 4500+

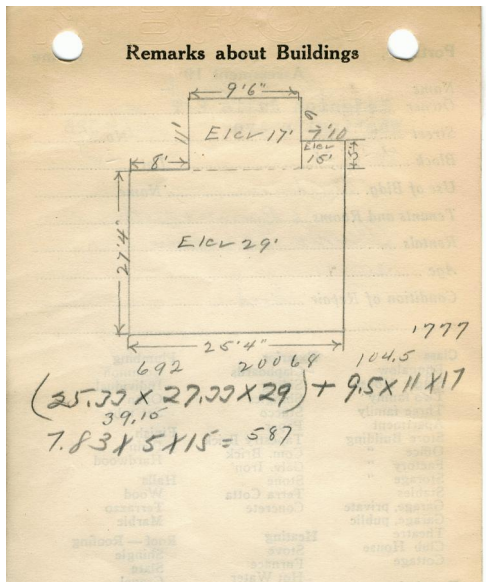

Remarks about Land

Remarks about Personal Property

ASSESSMENT DEPARTMENT

CHART	BLOCK
3 Building Volumes Checked	<i>MMS: Kent</i>
4 Building Values Placed	<i>1924</i>
5 Building Values Extended	
6 Land Only Questionnaire Made	
7 Land Values Placed	
8 Land Values Extended	
9 Compared With 1923	
10 Personal Property Added	

1924 Portland Tax Records: 526 Washington Avenue, Portland, 1924



Owner: Morris R. Schreiber
Address: 526 Washington Avenue, East Deering, Portland, Maine
Use: Residence
Local Code: Block 429J Lot 2 Book 79A Page 1
MMN item number: 82464