

1924 Portland Tax Records: 239-241 Walton Street, Portland, 1924

Portland, Maine
 Assessment 19
 Name
 Owner Morgan John J et als
 Street Walton No 239-241
 Block 143C Dingley Court Lot 5
 Use of Bldg. Dwelling Name
 Tenants and Rooms 2-8
 Rentals \$ 30 \$ 25
 Age 25
 Condition of Repair Good

Class	Exterior	Plumbing
Bungalow	Clapboards	Common
Single House	Siding	Individual
Two family	Shingles	Open
Three family	Stucco	Set tubs
Apartment	Paper	Finish
Store Building	Tapestry Brick	Plain
Office	Com. Brick	Hardwood
Factory	Galv. Iron	Halls
Storage	Stone	Wood
Stables	Terra Cotta	Terrazzo
Garage, private	Concrete	Marble
Garage, public		Roof - Roofing
Theatre	Heating	Shingle
Club House	Stove	Slate
Cottage	Furnace	Gravel
	Hot Water	Prepared
	Steam	Asbestos
Foundation	Light	Flat
Brick	Oil	Hip
Stone	Gas	Cable
Concrete	Electric	Dormers
Pile		Windows
Basement	Floor	Plain Glass
Full	Common	Wire Glass
Cement Floor	Hardwood	Shutters
Waterproof	Re-Concrete	Miscellaneous
Construction	Concrete Slab	Elevator
Frame	Waterproof	Sprinkler
Brick	Ceiling	Fire Escape
Tile	Plaster	Refrigerator
Blocks	Metal	Vacuum Cleaner
Stucco	Panelled	Safts and Vaults
Re-Concrete	Rough	Telephone Equip.
Mill		
Steel Frame		

Ground Area 10.36 Height 30' 12"
 Cubic Feet 276.24 Unit 18 cts
 Utility Dep. 30 Per cent.
 Dep. 30 Per cent.
 Sound Value, \$ 3481

Land 6000 Corner Interior Alley
 Front Depth = ft.
 COMPUTATION
 $6200 \times 100 \times .08 = 496.$
 $6200 \times .03 = 186$
 6800
 542

Area	Multiplier	Coefficient	
<u> 6200 </u>	<u> 100 </u>	<u> 6000 </u>	
Year	Unit	Coefficient	Land Value
19	<u> 08 </u>	<u> 6000 </u>	<u> \$ 480 550 </u>



Surveyed by A. C. MacGIBB
 JUN 24 1924
 (Remarks on other Side)

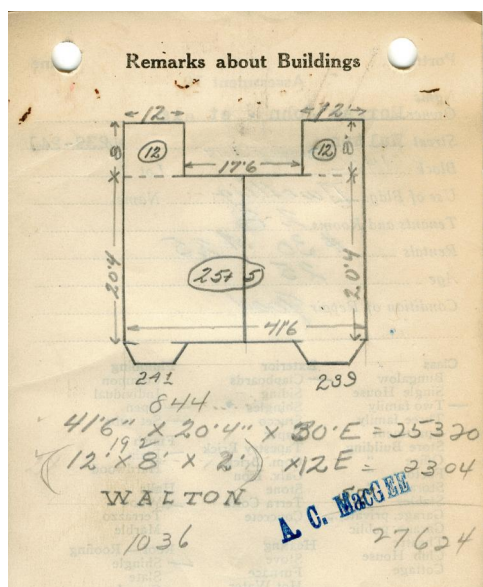

Remarks about Land

Remarks about Personal Property

CITY OF PORTLAND, MAINE
 ASSESSORS DEPARTMENT

CHART	BLOCK
3	Building Volumes Checked <u> HJA </u>
4	Building Values Placed <u> HJA </u>
5	Building Values Extended
6	Land Cert. Questionnaire Made
7	Land Values Placed
8	Land Values Extended
9	Comparative
10	Final Property Added

1924 Portland Tax Records: 239-241 Walton Street, Portland, 1924



Owner: John J. Morgan et als
Address: 239-241 Walton Street, Deering, Portland, Maine
Use: Dwelling - Two family
Local Code: Block 143C Lot 5 Book 77 Page 1
MMN item number: 83151