

1924 Portland Tax Records: 65 Waterville Street, Portland, 1924

Assessment 19

Port 1, L-400 13-1600 ine

Name Caritas Ellen

Owner Caritas Ellen

Street Waterville No. 65

Block 164 Lot 102

Use of Bldg. Dwelling Name _____

Tenants and Rooms 3 - 5 rms + bath

Rentals 3 @ \$200 - \$212 monthly

Age Old - top story, new - Renov-1924

Condition of Repair Fair

- | | | |
|---------------------|-------------------|-----------------------|
| Class | Exterior | Plumbing |
| Bungalow | Clapboards | Common |
| Single House | Siding | Individual |
| Two family | Shingles | Open |
| Three family flat | Stucco | Set tubs |
| Apartment | Paper | Finish |
| Store Building | Tapestry Brick | Plain |
| Office | Com. Brick | Hardwood |
| Factory | Galv. Iron | |
| Storage | Stone | Halls |
| Stables | Terra Cotta | Wood |
| Garage, private | Concrete | Terrazzo |
| Garage, public | | Marble |
| Theatre | Heating | Roof - Roofing |
| Club House | Stove | Shingle |
| Cottage | Furnace | Slate |
| | Hot Water | Gravel |
| | Steam - 1st floor | Prepared |
| Foundation | | Asbestos |
| Brick | Light | Flat |
| Stone | Oil | Hip |
| Concrete | Gas | Gable |
| Pile | Electric | Dormers |
| Basement | | Windows |
| Full | | Plain Glass |
| Cement Floor | | Wire Glass |
| Waterproof | | Shutters |
| Construction | | Miscellaneous |
| Frame | | Elevator |
| Brick | | Sprinkler |
| Tile | | Fire Escape |
| Blocks | | Refrigerator |
| Stucco | Ceiling | Vacuum Cleaner |
| Re-Concrete | Plaster | Safes and Vaults |
| Mill | Metal | Telephone Equip. |
| Steel Frame | Panelled | |
| | Rough | |

Ground Area 1010 Height 39' 3"

Cubic Feet 39210 Unit 15 cts

Utility Dep. _____

Dep. 20 Per cent.

Sound Value, \$ 4585

Land 2268 2356 Corner _____ Interior _____

Front _____ Depth _____ = _____ ft

2356 120 COMPUTATION

2268 x 108 x .12 = 294 339

2268 x 112 = 34 35

8 328 374

Area	Multiplier	Coefficient
		<u>0.12</u>
Year	Unit	Coefficient
19		<u>328</u>



Surveyed by John B. Kelly Feb. 11, 1925

(Remarks on other Side)

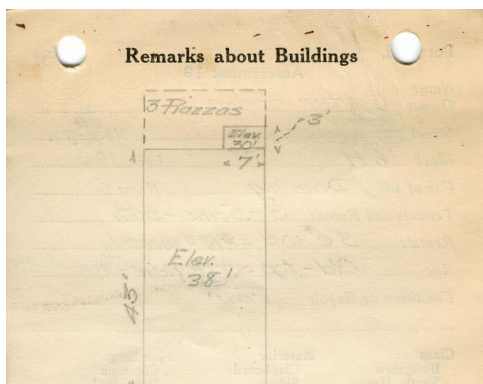

Waterville Street

$43 \times 23 = 989 \times 38 = 37,572$

$3 \times 7 = 21 \times 30 = 630$

1010 # 37,212 cuft

Remarks about Land

205 7/8

Remarks about Personal Property

1924 Portland Tax Records: 65 Waterville Street, Portland, 1924

www.mainmemory.net/item/83794
Collections of City of Portland - Planning & Development



Owner: Ellen Carter
Address: 65 Waterville Street, East End, Portland, Maine
Use: Dwelling
Local Code: Block 16H Lot 10 Book 80A Page 1
MMN item number: 83794