

1924 Portland Tax Records: 13-15 Winthrop Street, Portland, 1924

Port 1, ne
 Assessment 19
 Name
 Owner Better Sarah Just the Judge
 Street Winthrop No. 13-14
 Block 12 Lot 12
 Use of Bldg. Dwelling Name
 Tenants and Rooms 1 family
 Rentals
 Age Old
 Condition of Repair Good

- | | | |
|---------------------|-----------------|-----------------------|
| Class | Exterior | Plumbing |
| Bungalow | Clapboards | Common |
| Single House | Shing | Individual |
| Two family | Shingles | Open |
| Three family | Stucco | Set tubs |
| Apartment | Paper | Finish |
| Store Building | Tapestry Brick | Plain |
| Office | Com. Brick | Hardwood |
| Factory | Galv. Iron | Halls |
| Storage | Stone | Wood |
| Stables | Terra Cotta | Terrazzo |
| Garage, private | Concrete | Marble |
| Garage, public | | Roof - Roofing |
| Theatre | Heating | Shingle |
| Club House | Stove | Slate |
| Cottage | Furnace | Gravel |
| | Hot Water | Prepared |
| Foundation | Steam | Asbestos |
| Brick | Light | Flat |
| Stone | Oil | Hip |
| Concrete | Gas | Gable |
| Pile | Electric | Dormers |
| Basement | | Windows |
| Full | Floor | Plain Glass |
| Cement Floor | Common | Wire Glass |
| Waterproof | Hardwood | Shutters |
| Construction | Re-Concrete | Miscellaneous |
| Frame | Concrete Slab | Elevator |
| Brick | Waterproof | Sprinkler |
| Tile | Ceiling | Fire Escape |
| Blocks | Plaster | Refrigerator |
| Stucco | Metal | Vacuum Cleaner |
| Re-Concrete | Panelled | Safes and Vaults |
| Mill | Rough | Telephone Equip. |
| Steel Frame | | |

Ground Area 783 sq ft Height 19
 Cubic Feet 14886.5 Unit 200
 Utility Dep.
 Dep. 6.5 Per cent.
Sound Value, \$ 1042.90

Land 4790 Corner Interior Alley
 Front 52 Depth 63 ft.
 COMPUTATION

Area	Multiplier	Coefficient	
4790	108	5173	
Year	Unit	Coefficient	Land Value
19	.06		(310)



Surveyed by B.E. Cobb
 (Remarks on other Side)
24-1131-390-1000-1500
34-1131-392-2500-3000

Remarks about Buildings

17,251
 45,421
 3450
 6900
 6625
 6900
~~7835~~ 7835
 19
 70515
 7835
 14886.5 cul.

Remarks about Land

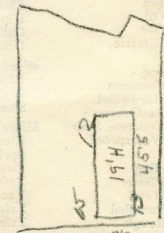

Winthrop St
 $17'3 \times 45'5 = 783.5 \times 19'0 = 14886.5$

Remarks about Personal Property

CITY OF PORTLAND, MAINE
 ASSESSORS DEPARTMENT

CHART	BLOCK
3	Building Volumes Checked <u>Full</u>
4	Building Values Placed <u>Full</u>
5	Building Values Extended
6	Land Only Questionnaire Made
7	Land Values Placed
8	Land Values Extended
9	Compared with 1923
10	Personal Property Added

1924 Portland Tax Records: 13-15 Winthrop Street, Portland, 1924



Owner: Sarah Potter
Address: 13-15 Winthrop Street, Portland, Maine
Use: Dwelling
Local Code: Block 12K Lot 12 Book 83A Page 1
MMN item number: 86565
Notes: Subsequently owned by John Lusthe